

Warners Bay
Belmont
Glendale
Swansea
Toronto
Morisset

CHARLESTOWN

STREETScape MASTER PLAN

Issue 01. Version 04. **March 2017**



Cardiff
Mount Hutton

DRAFT

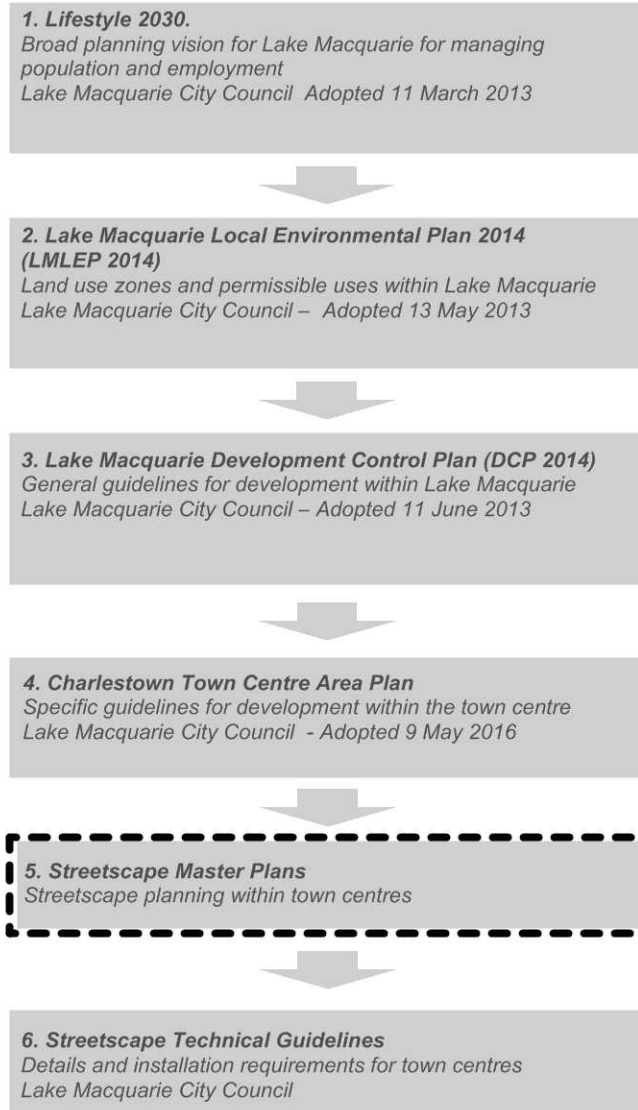

Note: the planning documents listed above are current at the time of adoption of this Streetscape Master Plan. When using these documents please confirm that you have the latest versions.

Issue	Ver.	Date	Notes
01	01	Feb 2012	For Exhibition
01	02	May 2012	For Adoption
01	03	Jun 2012	Adopted by Council
01	04	Mar 2017	Revised following adoption of Charlestown Area Plan Rev 10 and creation Streetscape Technical Guidelines

Owner: Asset Management
Users: All Council staff, the community and developers.
Prepared by: City Projects

LAKE MACQUARIE TOWN CENTRE STREETScape MASTER PLANS

The 2008/2009 Management Plan and Budget identified the need to provide high quality public domains and a city identity. The Streetscape Master Plans provide a document that identifies this vision and provides a plan for its implementation. The Streetscape Master Plans are intended to improve the aesthetic appearance of the town centres, promote the areas personality, increase opportunity, accessibility, functionality, economic effect and provide a modern easily maintainable public domain.

The Streetscape Master Plans ensure a unified approach to undertaking public domain works by Council, developers and the community. It also assists in directing public and private investments and will inform the chamber of commerce in the preparation of strategic plans.

The Streetscape Master Plans are substantially focused on the areas **subject to Area Plans under Lake Macquarie LEP 2014**. These are the areas of each of the town centres where the majority of commercial activity will occur. These areas are also the most likely to undergo change in the future.

The consideration and collation of all relevant issues resulted in this overall priority order for the Streetscape Master Plans:

1. Charlestown - completed and adopted by Council
2. Cardiff - completed and adopted by Council
3. Belmont - completed and adopted by Council
4. Toronto - completed and adopted by Council
5. Morisset - completed and adopted by Council
6. Warners Bay - completed and adopted by Council
7. Swansea - completed and adopted by Council
8. Mount Hutton - completed and adopted by Council
9. Glendale - completed and adopted by Council

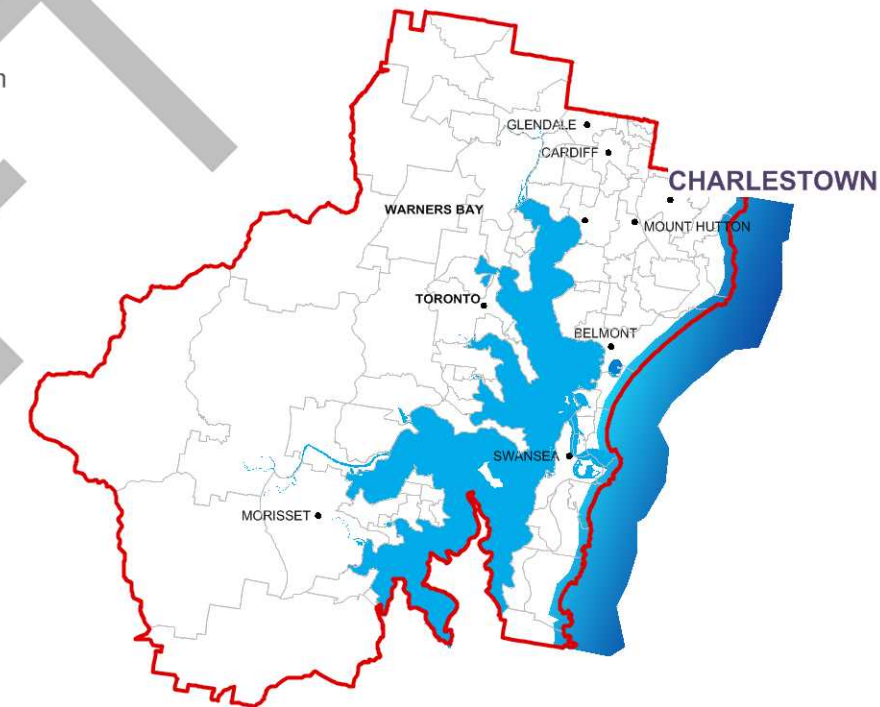

OBJECTIVES OF TOWN CENTRE STREETScape MASTER PLANS

- To provide a clear vision and identity for each town centre
- To provide a clear guide for Council, the community and developers
- To create vibrant active town centres
- To preserve and enhance the uniqueness of Lake Macquarie's town centres
- To ensure high quality outcomes
- To reduce asset maintenance costs

EXTENT OF THE CHARLESTOWN TOWN CENTRE STREETScape MASTER PLAN

Generally aligned with the Area Plan, the areas covered by the *Streetscape Master Plan* are the public areas owned and /or managed by council. The focus is on the streetscape elements within the road reserve and include street trees, tree guards, furniture, bins, bike racks, drinking fountains, bollards, lighting, paving, public art and town centre signage. For consistency the streetscape treatments should be extended onto private land at building setbacks, building forecourts, arcade entrances, pedestrian lanes etc. and where logical to address pedestrian links. New developments need to address the streetscape as prescribed by this plan. Items and selections nominated in this plan will be reviewed periodically by LMCC in accordance with relevant legislation.

TOWN CENTRE PERSONALITIES

Town centre personalities have been developed for the nine main town centres. These have been derived to provide a strong town centre identity and theme for enhancing character, heritage and sense of place.

- The nine main town centres personalities are:
- Charlestown - the Central Business District**
 - Cardiff - the Skills & Trades Centre
 - Belmont - the Activity Centre
 - Toronto - the Lakeside Village
 - Morisset - Nurtures the Spirit of Community
 - Warners Bay - the Lifestyle Centre
 - Glendale - the Dynamic Services Hub
 - Swansea - the Seaside Village
 - Mount Hutton - the Growing Community

OBJECTIVES / VISION

- To create a vibrant new town centre
- To enhance the town centres personality
- To enhance safety and accessibility
- To create a consistent character
- To link key areas
- To provide a sustainable environment
- To provide facilities for public art
- To protect and enhance Charlestown's heritage
- To provide inviting town centre signage
- To connect the town centre with parks and open spaces
- To create clean lines and reduce street clutter
- To provide high quality furniture, lighting and paving
- To retain on street parking to support businesses
- To provide for transport options in the town centre
- To enhance the character of surrounding streets
- To retain and protect significant trees
- To promote walking, cycling and public transport
- To activate Charlestown Mall as a safe and inviting destination
- To reinforce Pearson St as the key north-south pedestrian spine
- To create hubs for alfresco dining in a number of locations.

CONSTRAINTS

- Building setbacks are inconsistent.
- Council has limited ability to influence streetscape treatments behind property line.
- Extent of existing development.

NOTE:

Refer page 1 for PLANNING CONTROLS

ADDITIONAL PLANNING CONSIDERATIONS FOR CHARLESTOWN STREETScape MASTER PLAN:

- The Charlestown Transportation Strategy
- Town Centre Personalities.
- Charlestown Economic Development Plan - A Guide to Town Centre 3 Year Strategic Plans - Adopted
- Draft Asset Management Plans - Current conditions and replacement schedule
- LMCC Public Art Policy
- LMCC Cycling Strategy 2021.
- LMCC Public Art Strategy.
- LMCC Footpath Strategy.
- LMCC Public Lighting Policy.
- LMCC Banner Policy For long-term (ongoing) banner installation - 2012.
- Management of Trees on Roads and Public Reserves Policy.

These documents have been reviewed and considered as part of this plan. Where these initiatives or any others are adopted or modified the Streetscape Master Plan should be updated to reflect this.

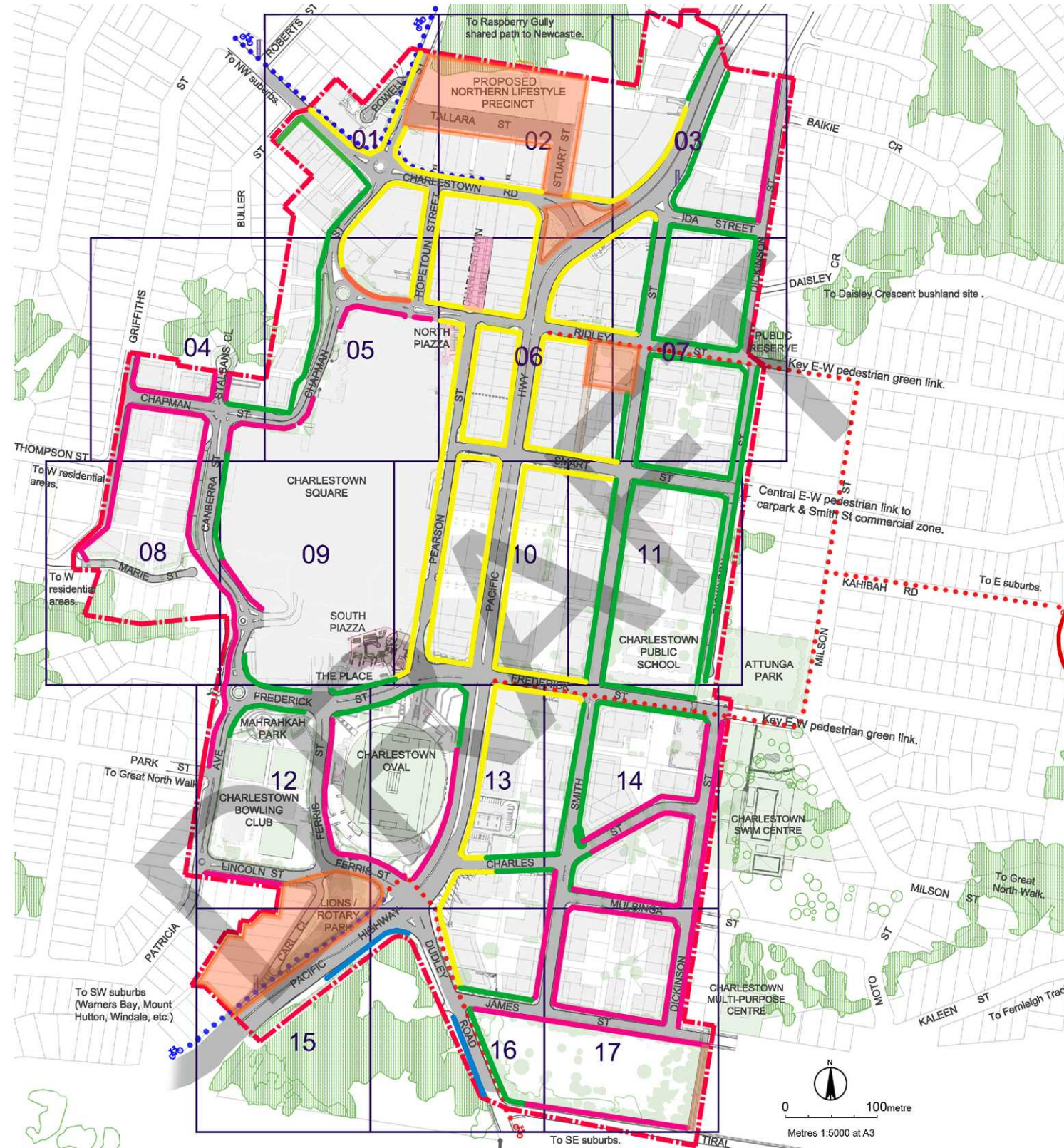

LEGEND

- Extent of Charlestown Streetscape Master Plan
- Orange Area Areas subject to detailed design process
- Pink Area Urban spaces with alfresco dining opportunities
- Green Area Green spaces
- Brown Area Shared zones for traffic calming, vehicle/cycle/pedestrian sharing
- Red Dotted Line with Bicycle Icon Proposed on road cycleway
- Blue Dotted Line with Bicycle Icon Proposed off road cycleway
- Yellow Line Pavement Treatment Type P1
- Green Line Pavement Treatment Type P2
- Pink Line Pavement Treatment Type P3

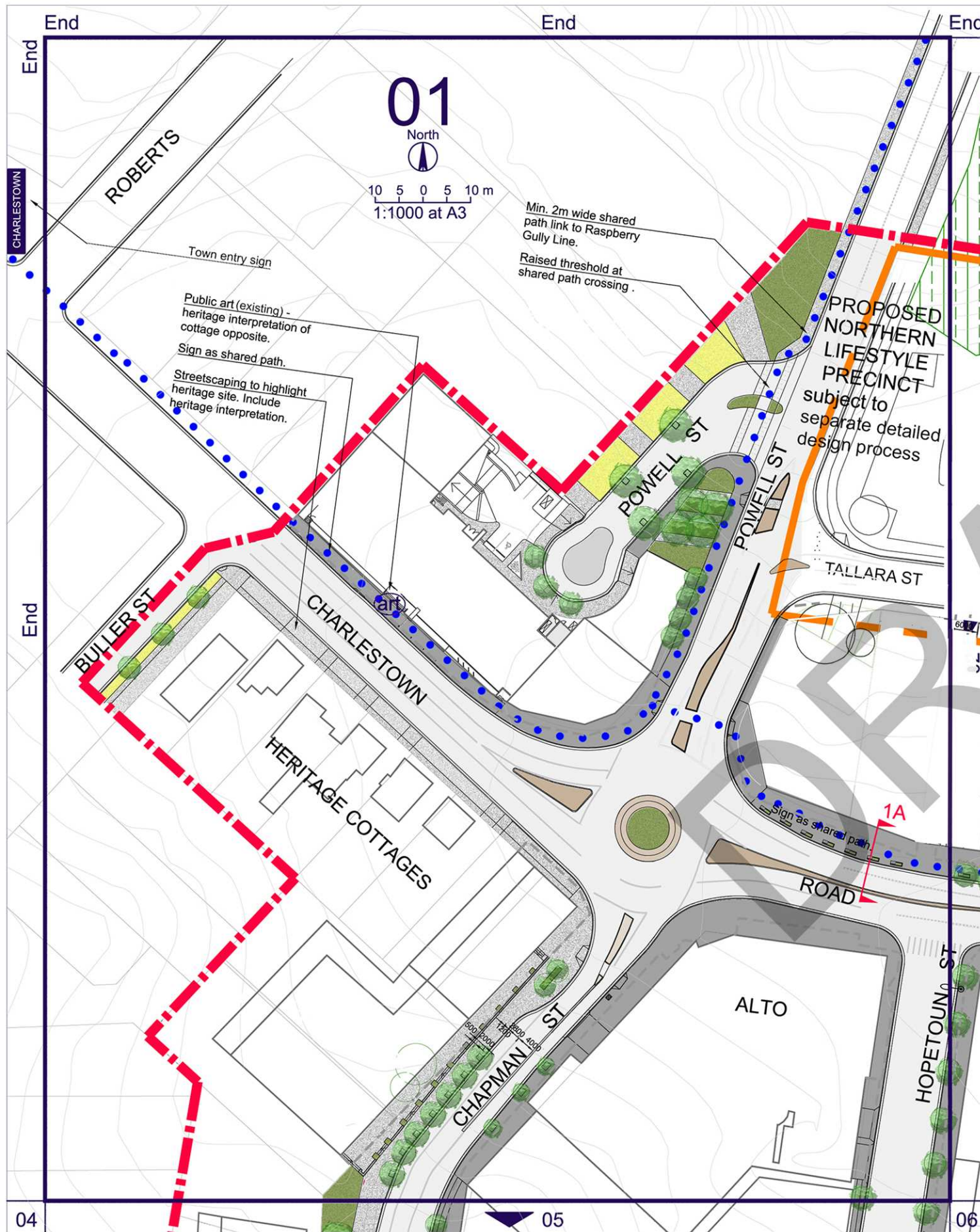

- Extent of Charlestown Streetscape Master Plan
- Areas subject to separate master plan process
- Green spaces
- Unit Paving - Pavement treatment type P1 - refer to page 22 of this plan.
- Concrete pavement with Unit paver banding - Pavement Treatment types 1 and 2 - refer to page 23 + 24 of this plan.
- Permeable paving. Refer Streetscape Technical Guidelines.
- Proposed off road cycleway - refer to LMCC Cycling Strategy 2011-2021
- Proposed on road cycleway - refer to LMCC Cycling Strategy 2011-2021
- Groundcover planting. Refer Streetscape Technical Guidelines for species list.
- Turf. Refer to the Streetscape Technical Guidelines
- Existing & proposed tree planting. Refer Streetscape Technical Guidelines for species list.
- Existing & proposed trees & vegetation on private land / council reserves.
- Existing public art site
- Future public art opportunity - Refer to Streetscape Technical Guidelines.
- Bus stop. Refer Streetscape Technical Guidelines.
- Street Light Poles - new steel standard Energy Australia poles. Refer to Streetscape Technical Guidelines.
- Street Light Poles - new steel Vic Poles with banner mountings. Refer Streetscape Technical Guidelines.
- Pedestrian light pole. Refer to Streetscape Technical Guidelines.
- Traffic light.
- TOWN ENTRY SIGN - refer to Streetscape Technical Guideline.
- Custom bench seat - refer to Streetscape Technical Guideline.
- Bench seat with back - refer to Streetscape Technical Guideline.
- Raised planter. Refer Streetscape Technical Guideline.
- Alfresco dining.
- Wall - refer to Streetscape Technical Guideline.
- Bollards - refer to Streetscape Technical Guideline.
- Bike racks - refer to Streetscape Technical Guideline.
- Bins - refer to Streetscape Technical Guideline.

GENERAL NOTES:

- Refer to the the Streetscape Technical Guidelines for all furniture, paving, planting and public art specifications.
- Tree species selections are provided in the technical guidelines. Please note that symbols as drawn on the master plan are graphic symbols and should not be taken as a definite indication of either installation size nor mature size of proposed trees.

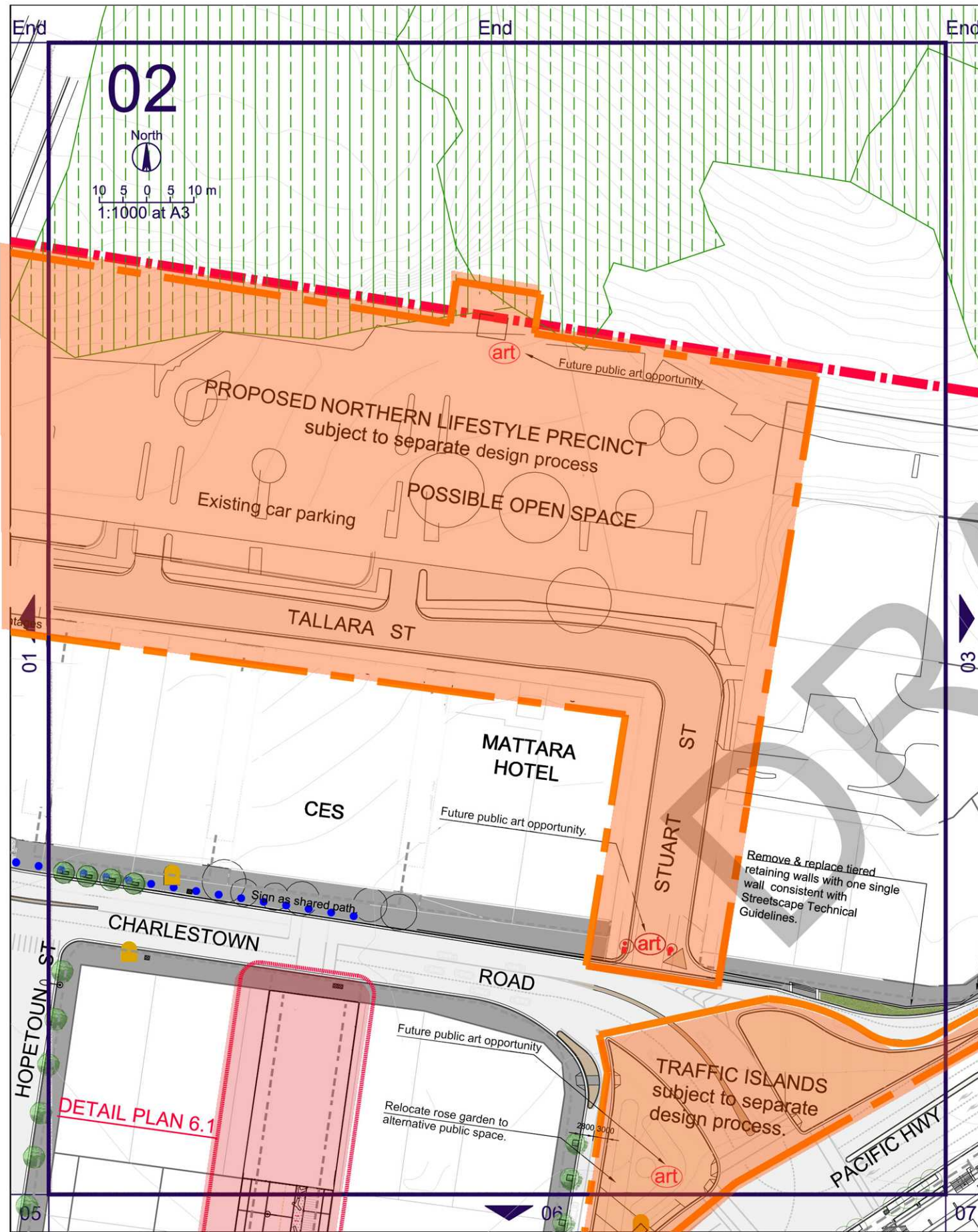

GENERAL NOTE: Refer to the Streetscape Technical Guidelines for all furniture, paving, planting and public art specifications. Refer to page 4 of this document for the plan legend.

NORTHERN LIFESTYLE PRECINCT
 The northern lifestyle precinct will create a significant number of new residences and will be supported a high quality public domain that will include play spaces and other family-friendly features.

TRAFFIC ISLANDS
 The Traffic Islands will be redeveloped as the location for a significant, large-scale contemporary artwork.

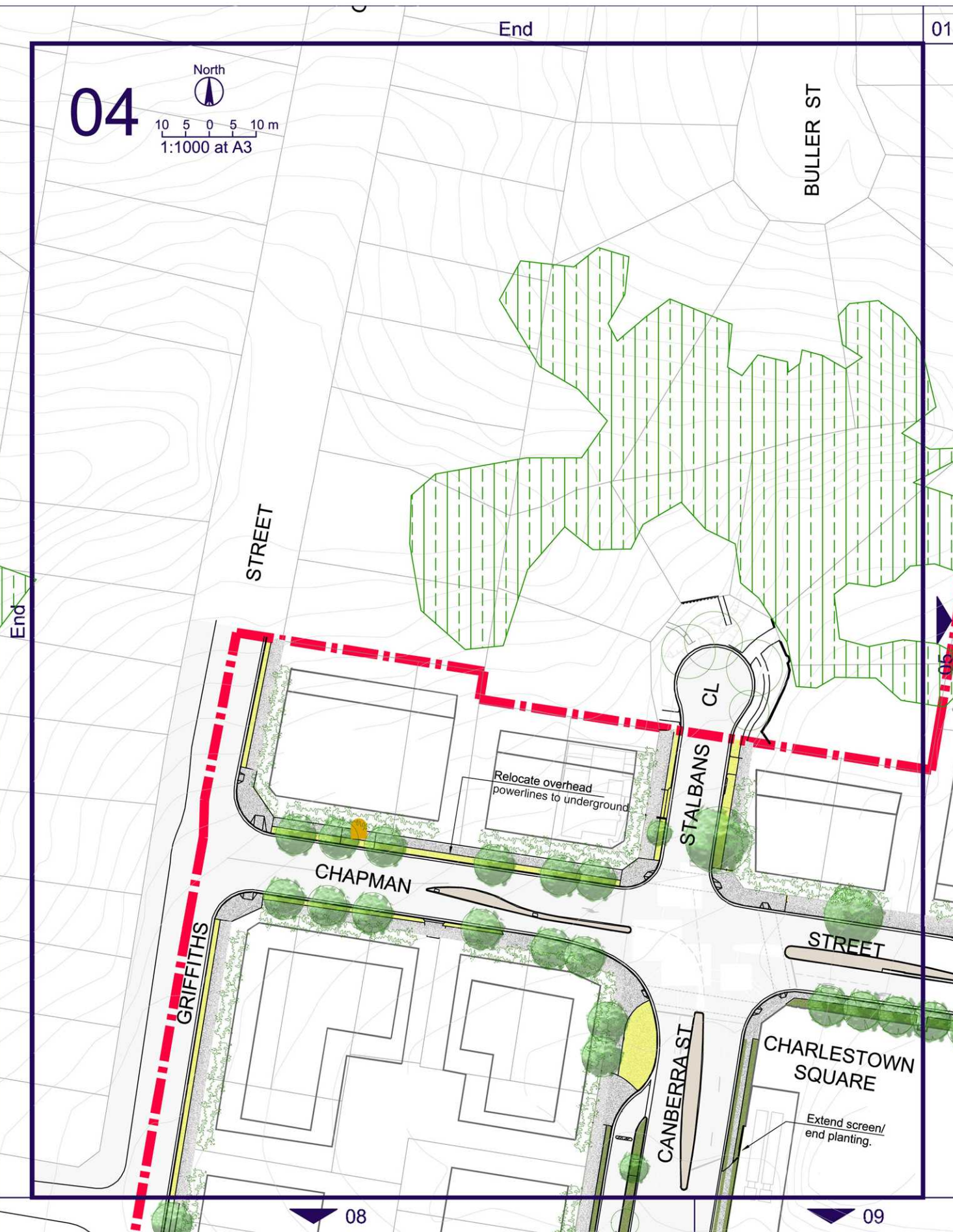

Chapman Street looking west



Chapman Street looking east



Canberra St north

GENERAL NOTE: Refer to the Streetscape Technical Guidelines for all furniture, paving, planting and public art specifications. Refer to page 4 of this document for the plan legend.

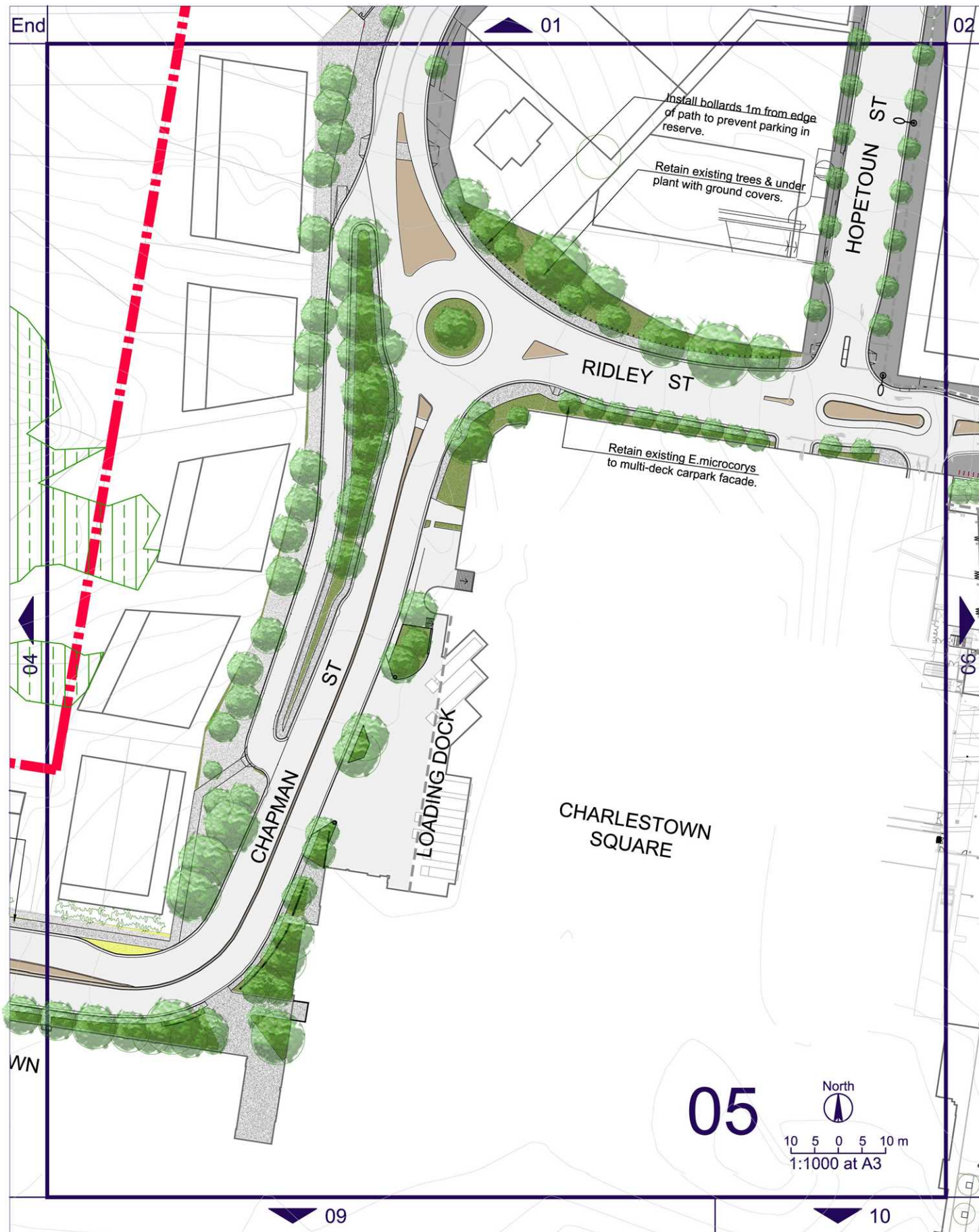

Hopetoun St: Full width unit paving to commercial zoning & street trees located in footpath or road pavement.

GENERAL NOTE: Refer to the Streetscape Technical Guidelines for all furniture, paving, planting and public art specifications. Refer to page 4 of this document for the plan legend.

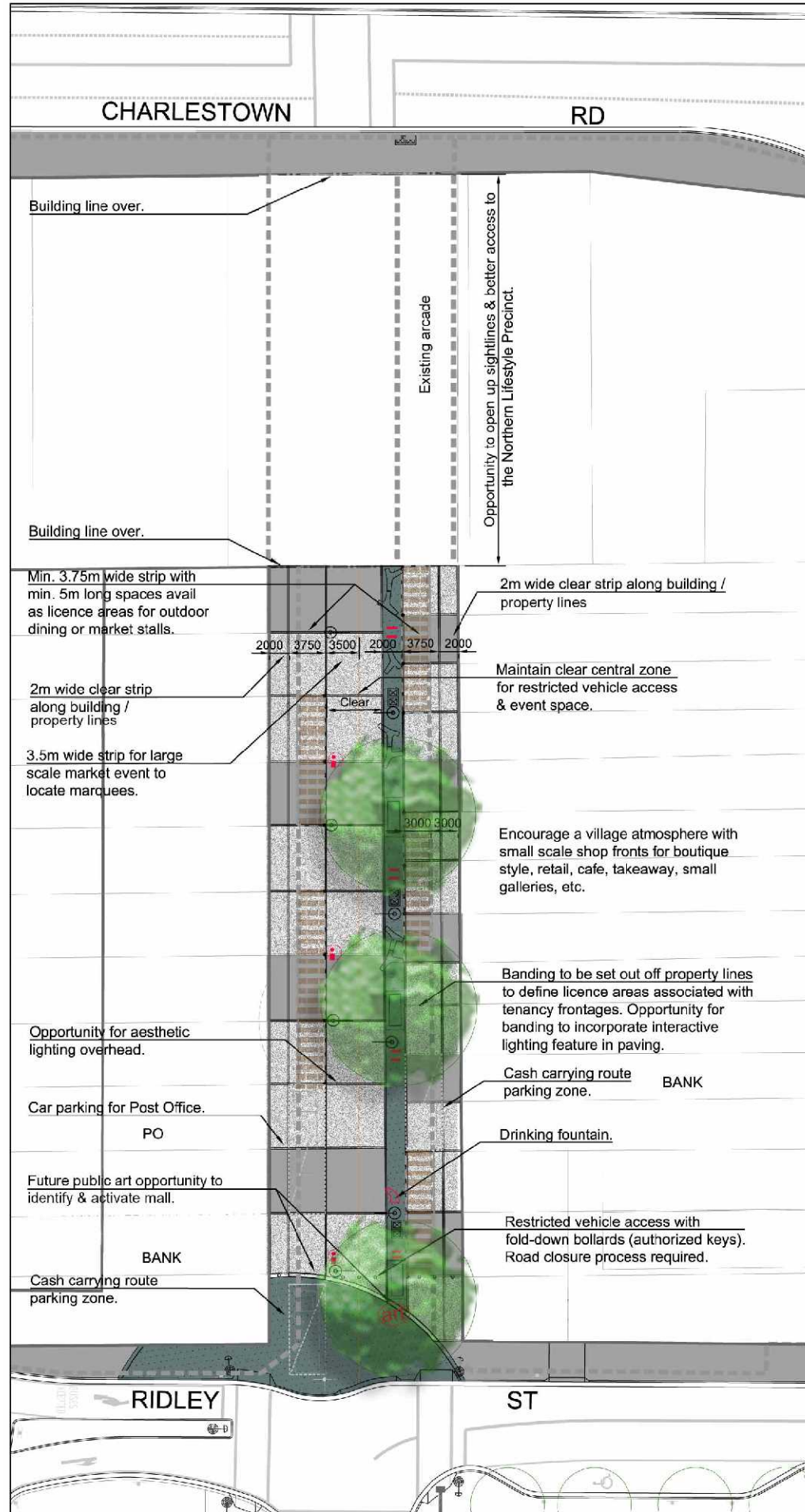

LEGEND & NOTES

- Proposed advanced native spices tree with raised planter.
- Remove existing trees & replace with advanced native spices to deter non-native birds.
- Light poles refer to Charlestown Streetscape Technical Guidelines.
- Information sign refer to Charlestown Streetscape Technical Guidelines.
- 3m wide awning with potential for 1st floor dining over. 3m wide pergola sections to extend over some alfresco areas.
- Full width unit paving with banding to replace existing brick paving. Remove all ground covers to address vermin issues.
- Paving type 2
- 2m wide strip permeable paving under proposed trees & kiosks.
- Custom seats arranged in groups.
- Pairs of waste & recycling bins.
- Pairs of bike racks.
- Drinking fountain.

Note: Furniture refer to Charlestown Streetscape Technical Guideline.



Charlestown Mall character images.

CHARLESTOWN MALL

This proposed design provides for an upgrade of Charlestown Mall as a pedestrian-friendly urban space that is activated with alfresco dining, outdoor activities, public art, poster columns and community information stands. An upgraded mall could provide opportunities for kiosk style facilities with take away food, coffee & cakes, newsagency, flowers, juice stalls, and the like in the mall. These may be an option to introduce low risk commercial activity where activation is critical to the success of outdoor areas, or would only be filled at a later date when other tenancies are occupied. The public consultation process identified an overwhelming desire to maintain trees in the mall however problems with feral bird species and the domination of the space are associated with the existing trees, particularly the central Plane Tree. The design would remove groundcover planting that may harbour vermin, replace the existing brick paving with new paving, upgrade existing bench seats with more contemporary multi-purpose custom-designed modular seating, improve pedestrian lighting. The master plan provides a proposal to removal all existing trees and replace with 3 super-advanced trees down the eastern side of the mall. The species selection will aim to discourage pest species such as Indian Minahs.



Northern Arcade: Widen to full width and min. 2 storeys. Activate with kiosks & alfresco.

GENERAL NOTE: Refer to the Streetscape Technical Guidelines for all furniture, paving, planting and public art specifications. Refer to page 4 of this document for the plan legend.

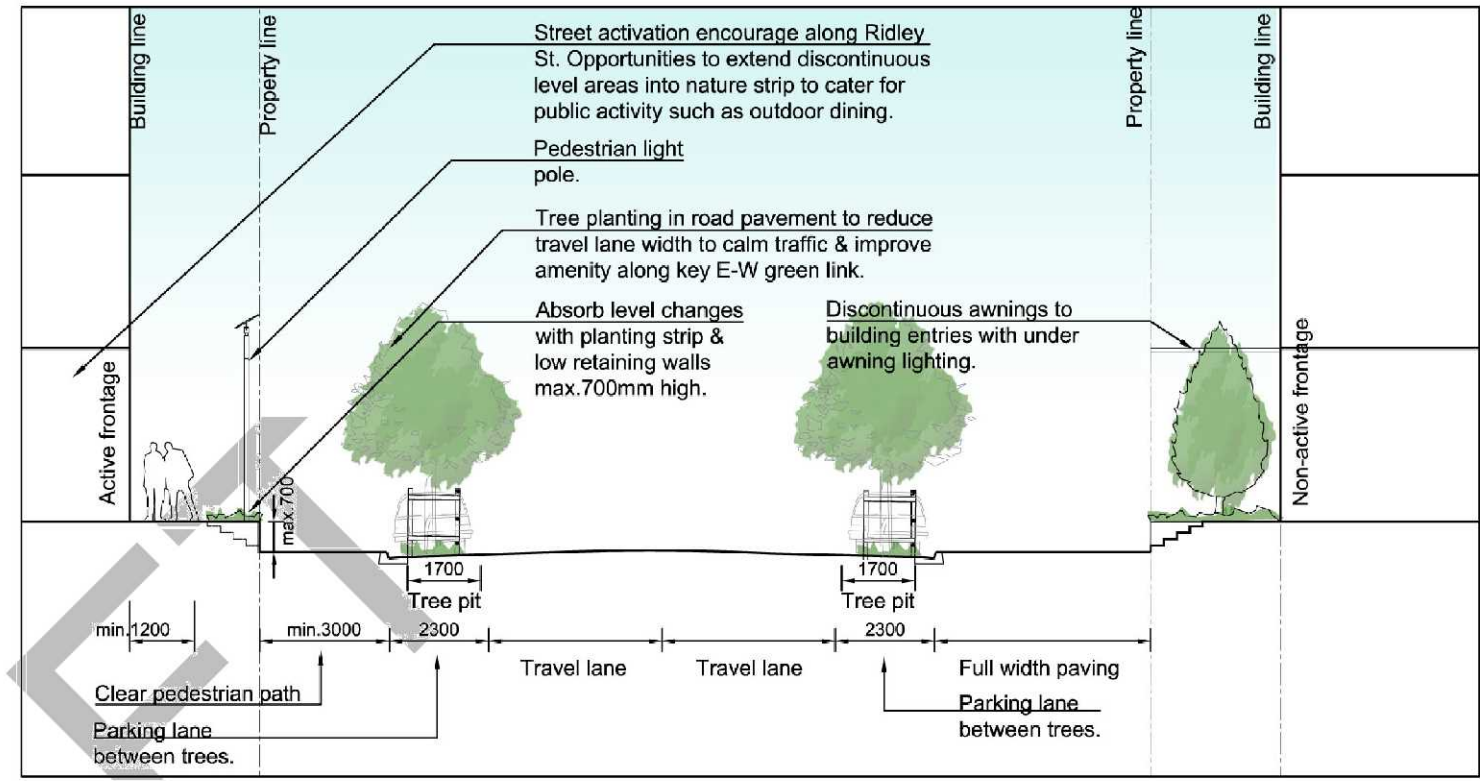
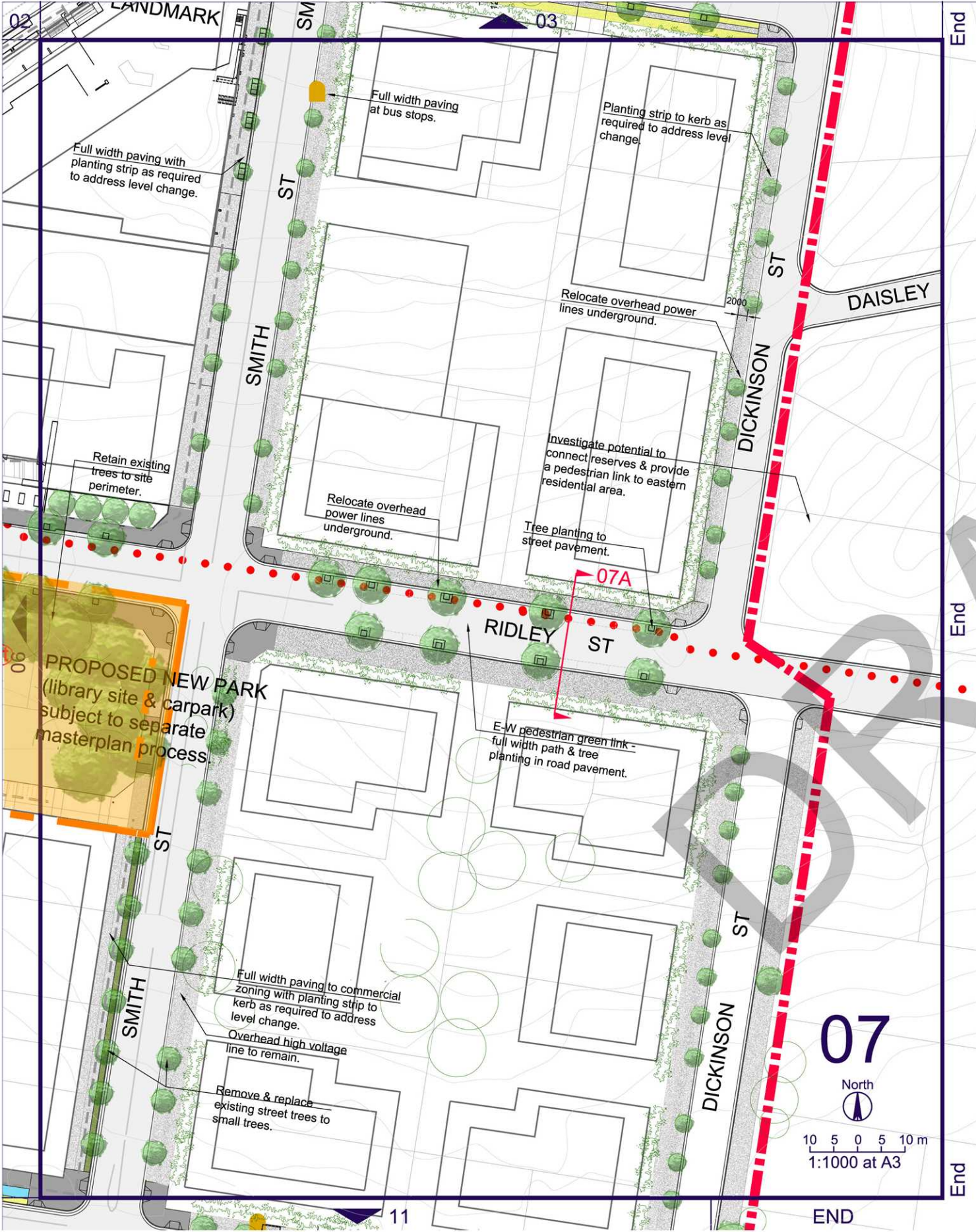

Dickinson St Resolve cross-falls to nature strip behind property line.



Ridley St



Tree planting in road pavement. Example treatment proposed for eastern end of Ridley Street. Mixed use zone.



Smith St Full width pavements to western side between Ida and Frederick Streets.

GENERAL NOTE: Refer to the Streetscape Technical Guidelines for all furniture, paving, planting and public art specifications. Refer to page 4 of this document for the plan legend.

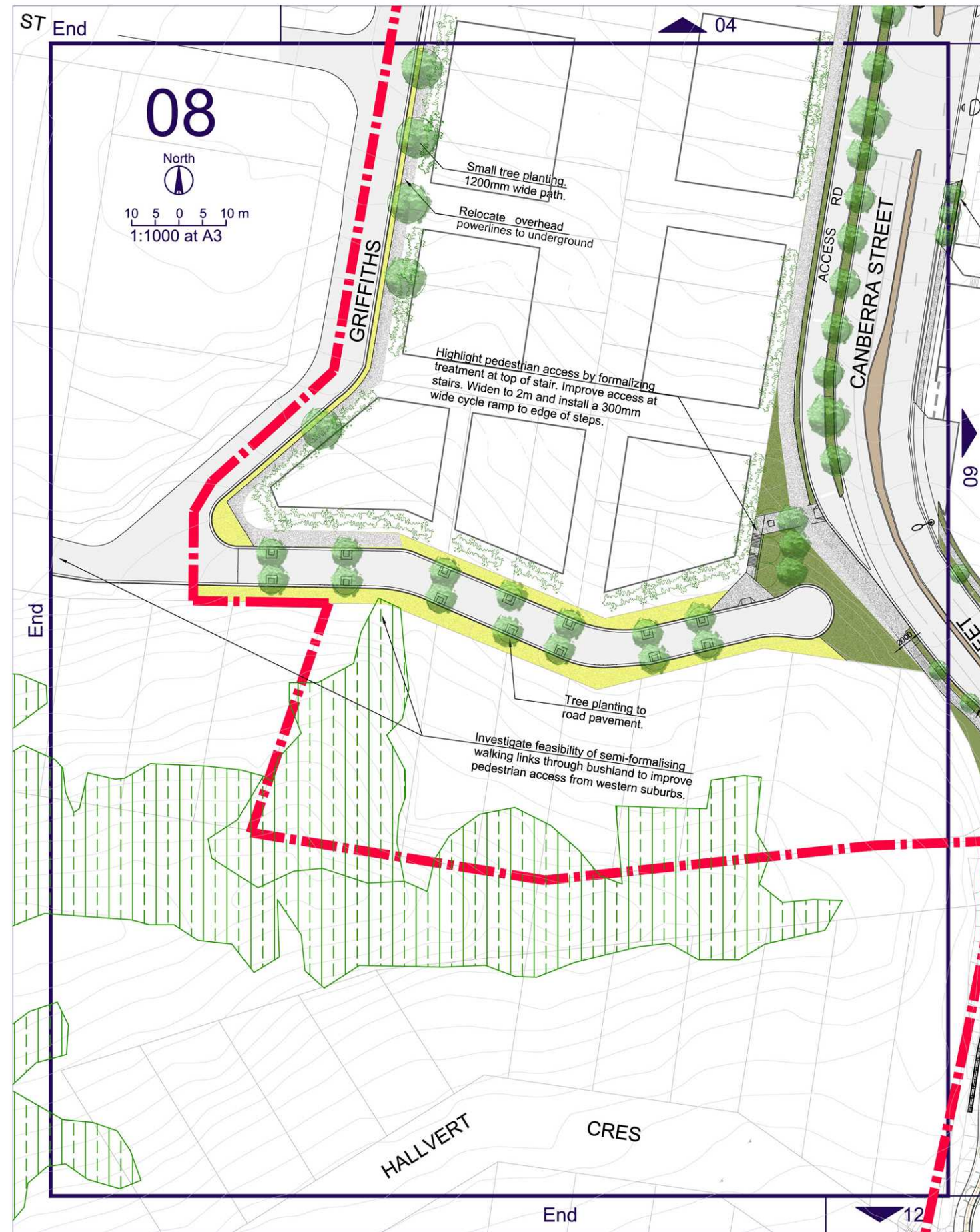

Canberra St looking south from lane



Laneway off Canberra St



Laneway off Canberra St



Marie St (eastern end)



Marie St (east of Griffiths)



Griffiths St (Chapman to Marie). Proposed 1200mm path & small tree planting under power lines.

GENERAL NOTE: Refer to the Streetscape Technical Guidelines for all furniture, paving, planting and public art specifications. Refer to page 4 of this document for the plan legend.

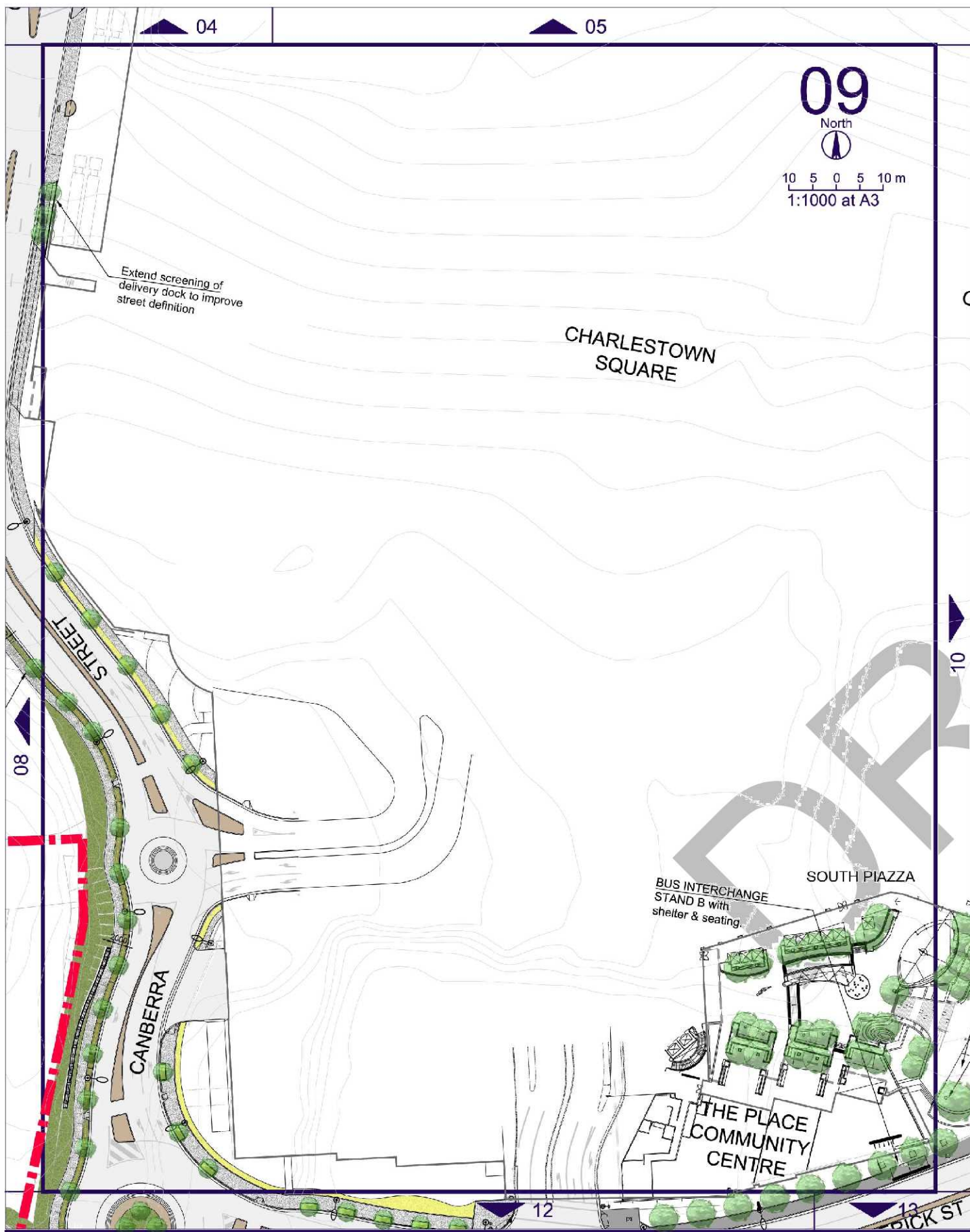

GENERAL NOTE: Refer to the Streetscape Technical Guidelines for all furniture, paving, planting and public art specifications. Refer to page 4 of this document for the plan legend.

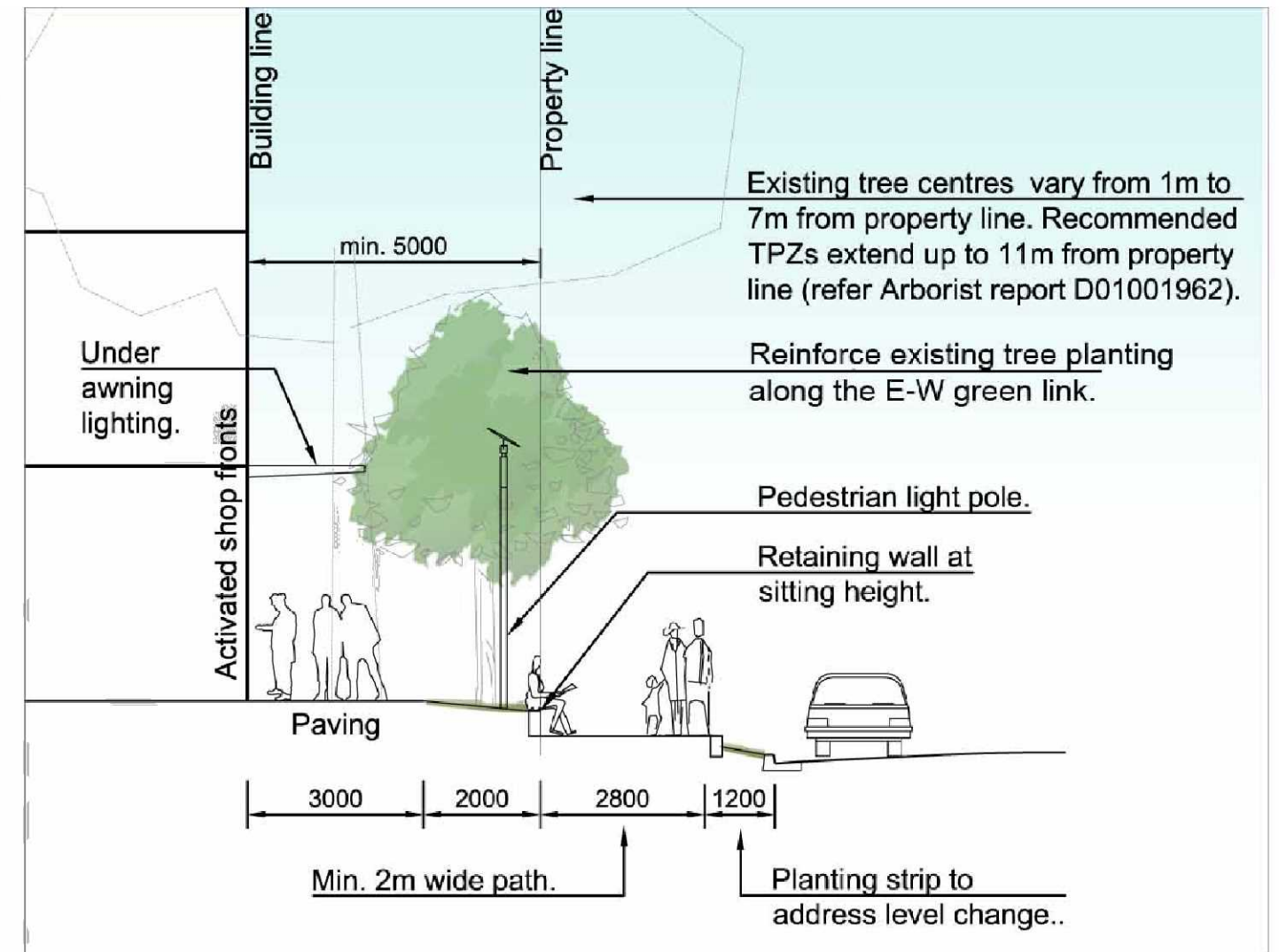
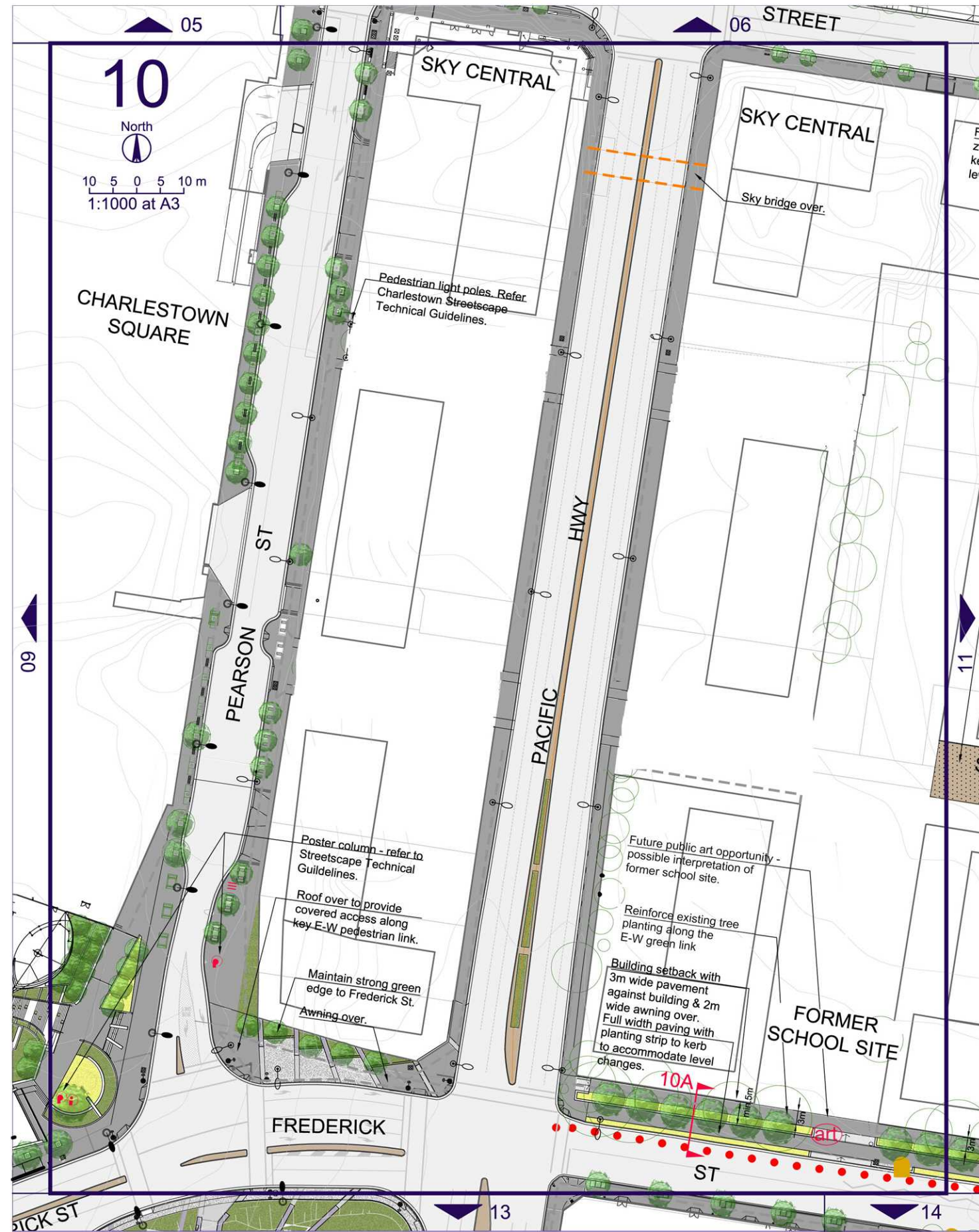

SECTION 10A NTS

Frederick Street at former public school site: Key E-W Greenway. Retain existing trees to boundary.



GENERAL NOTE: Refer to the Streetscape Technical Guidelines for all furniture, paving, planting and public art specifications. Refer to page 4 of this document for the plan legend.

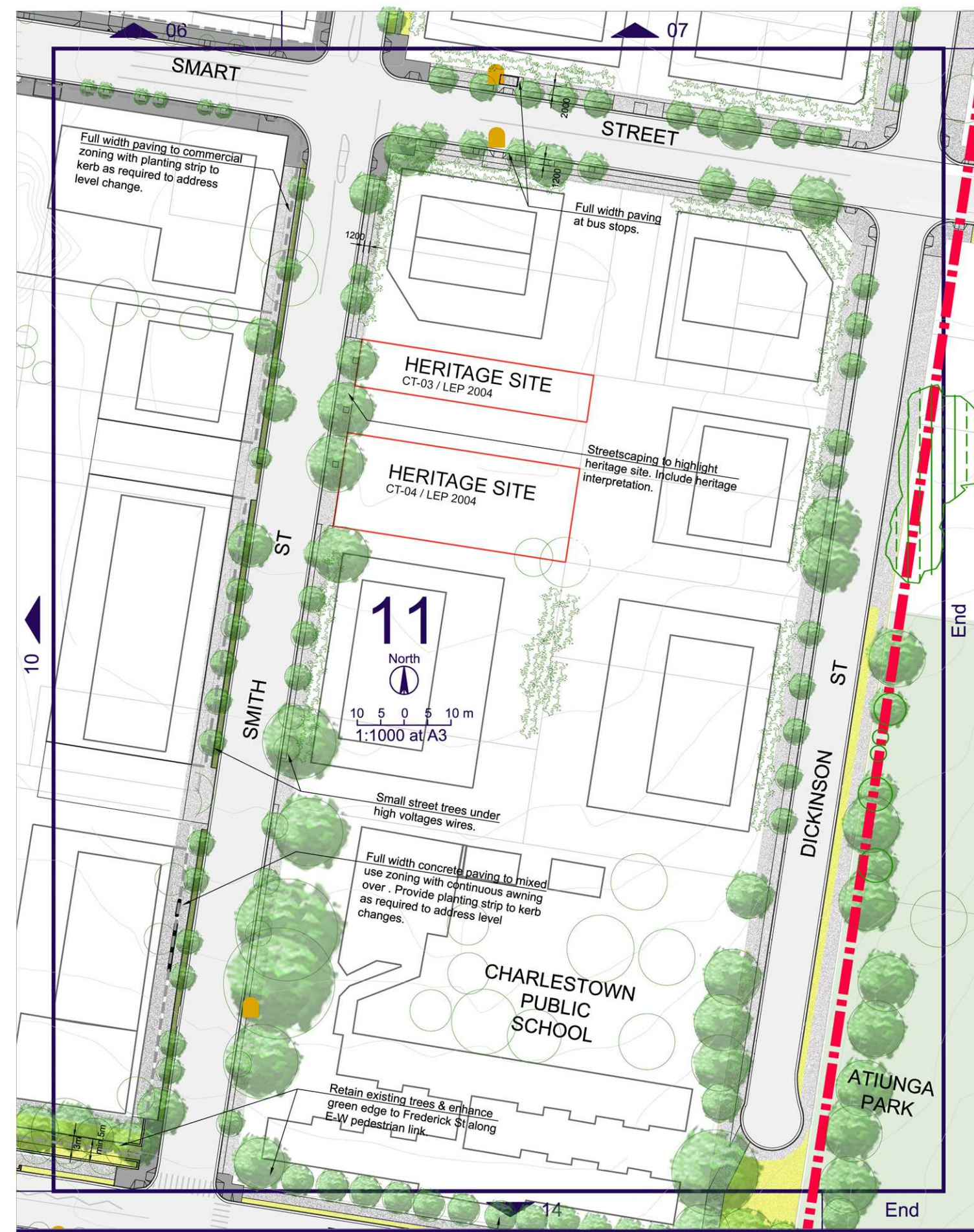

Dickinson St (Between Smart and Frederick)



Road closure between Dickinson and Frederick St

GENERAL NOTE: Refer to the Streetscape Technical Guidelines for all furniture, paving, planting and public art specifications. Refer to page 4 of this document for the plan legend.

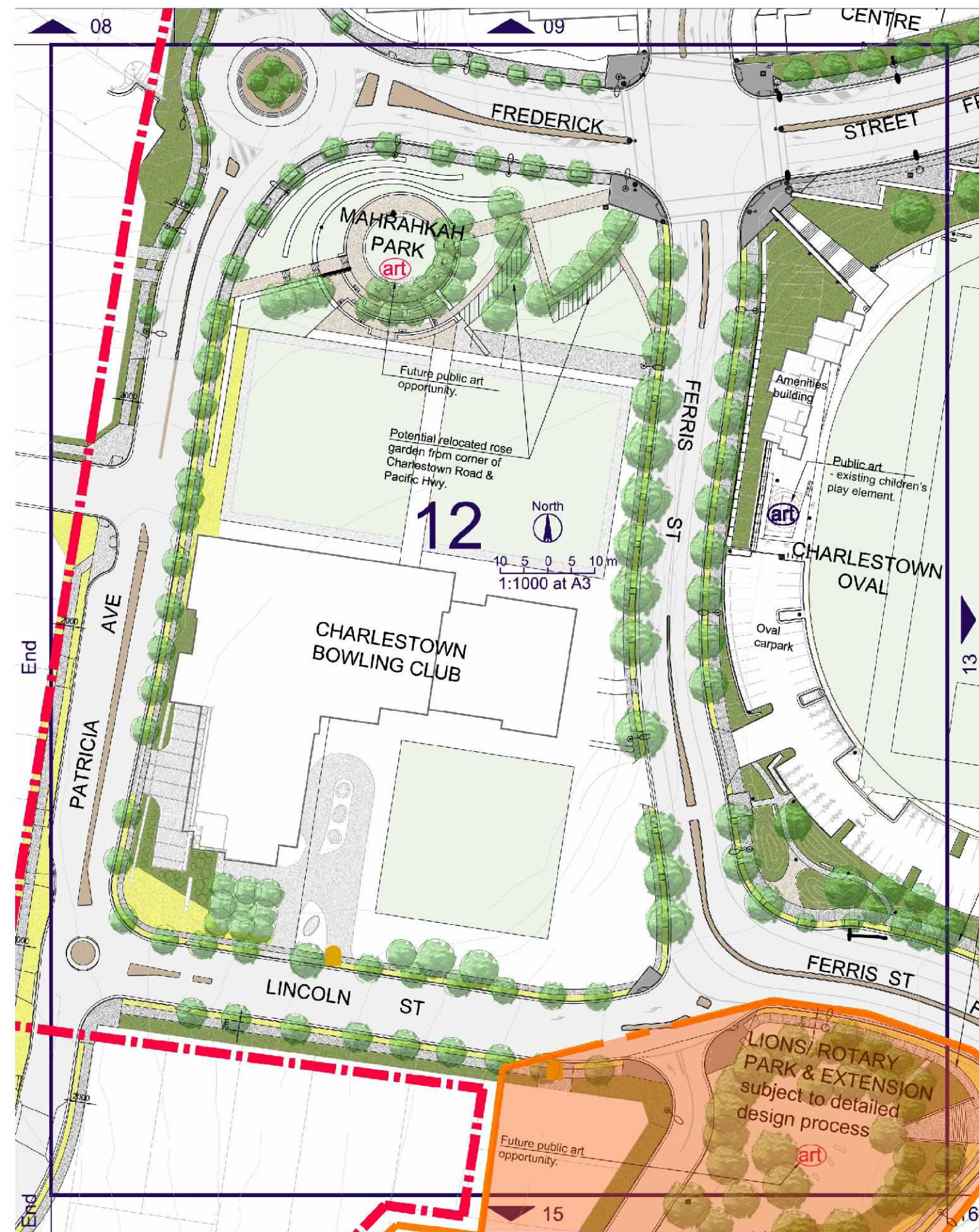

Lions/Rotary Park



Lincoln St

GENERAL NOTE: Refer to the Streetscape Technical Guidelines for all furniture, paving, planting and public art specifications. Refer to page 4 of this document for the plan legend.

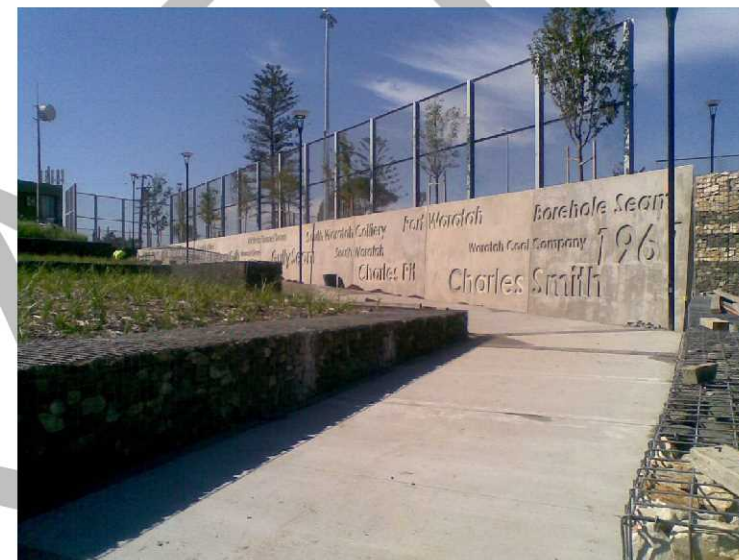
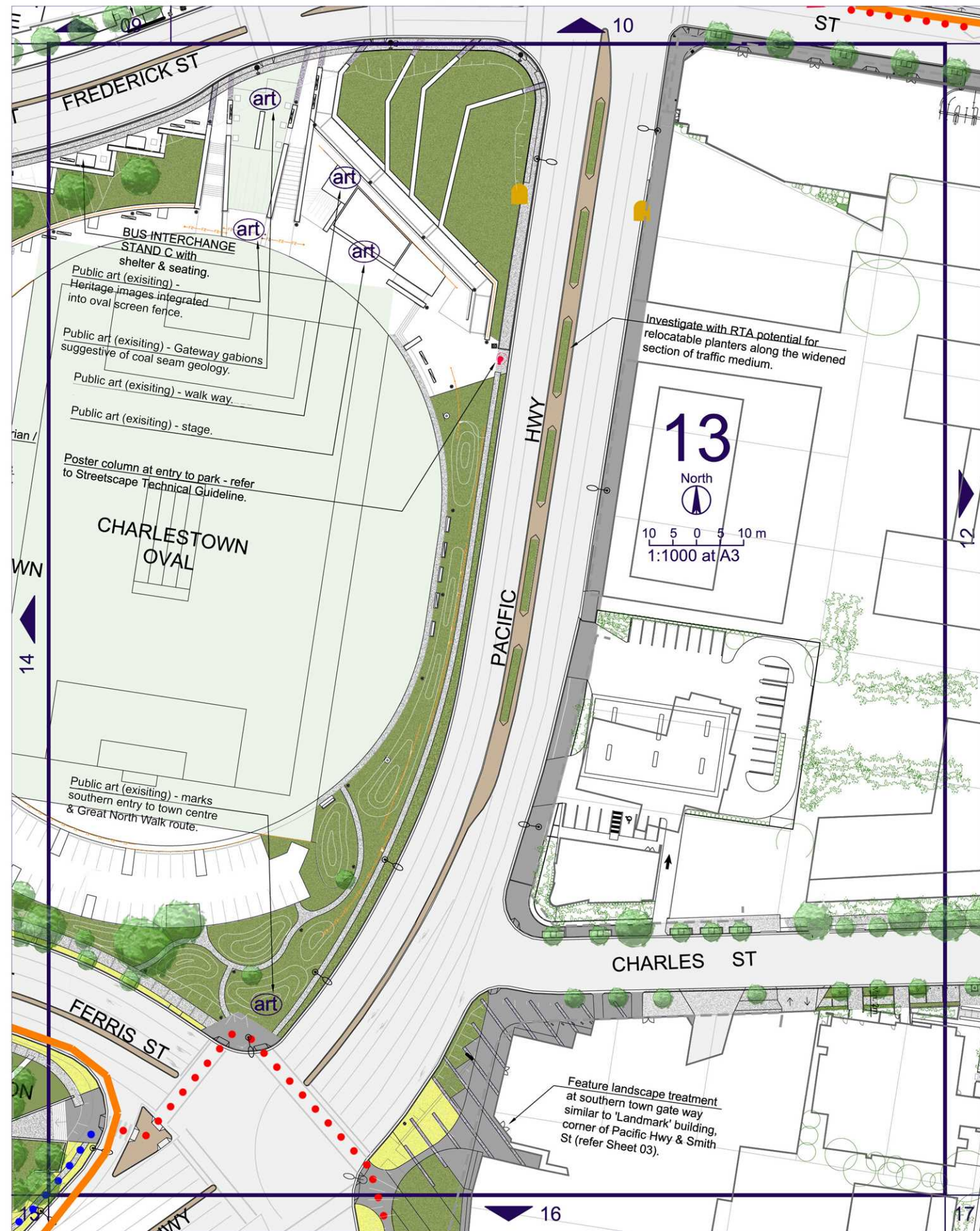

Completed public art works near Charlestown Oval.

GENERAL NOTE: Refer to the Streetscape Technical Guidelines for all furniture, paving, planting and public art specifications. Refer to page 4 of this document for the plan legend.

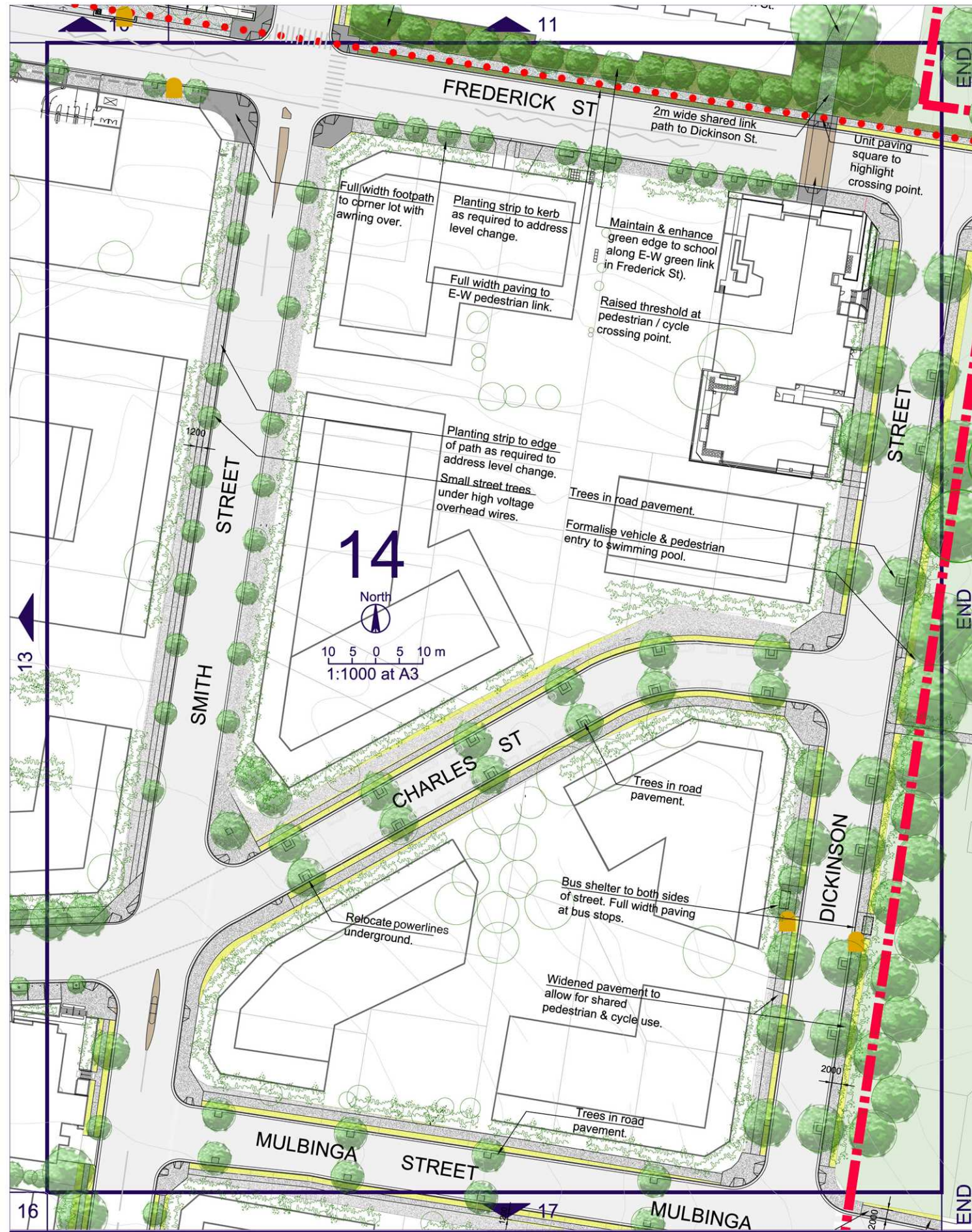

Frederick St (Public school frontage): Maintain large structural trees along Frederick St frontage of school site to improve street amenity along key E-W pedestrian greenway.



Corner Charles and Smith: Proposed treatment. Image: Next Architects



Dickinson St (eastern side)



Dickinson St (eastern cycle by-pass around town centre)



Mulbonga St: Min 2m wide path to



Smith St (south of Frederick St): 1200mm wide path to residential frontages both sides of the street.



CharlesSt (Southern side)

GENERAL NOTE: Refer to the Streetscape Technical Guidelines for all furniture, paving, planting and public art specifications. Refer to page 4 of this document for the plan legend.

Character Images

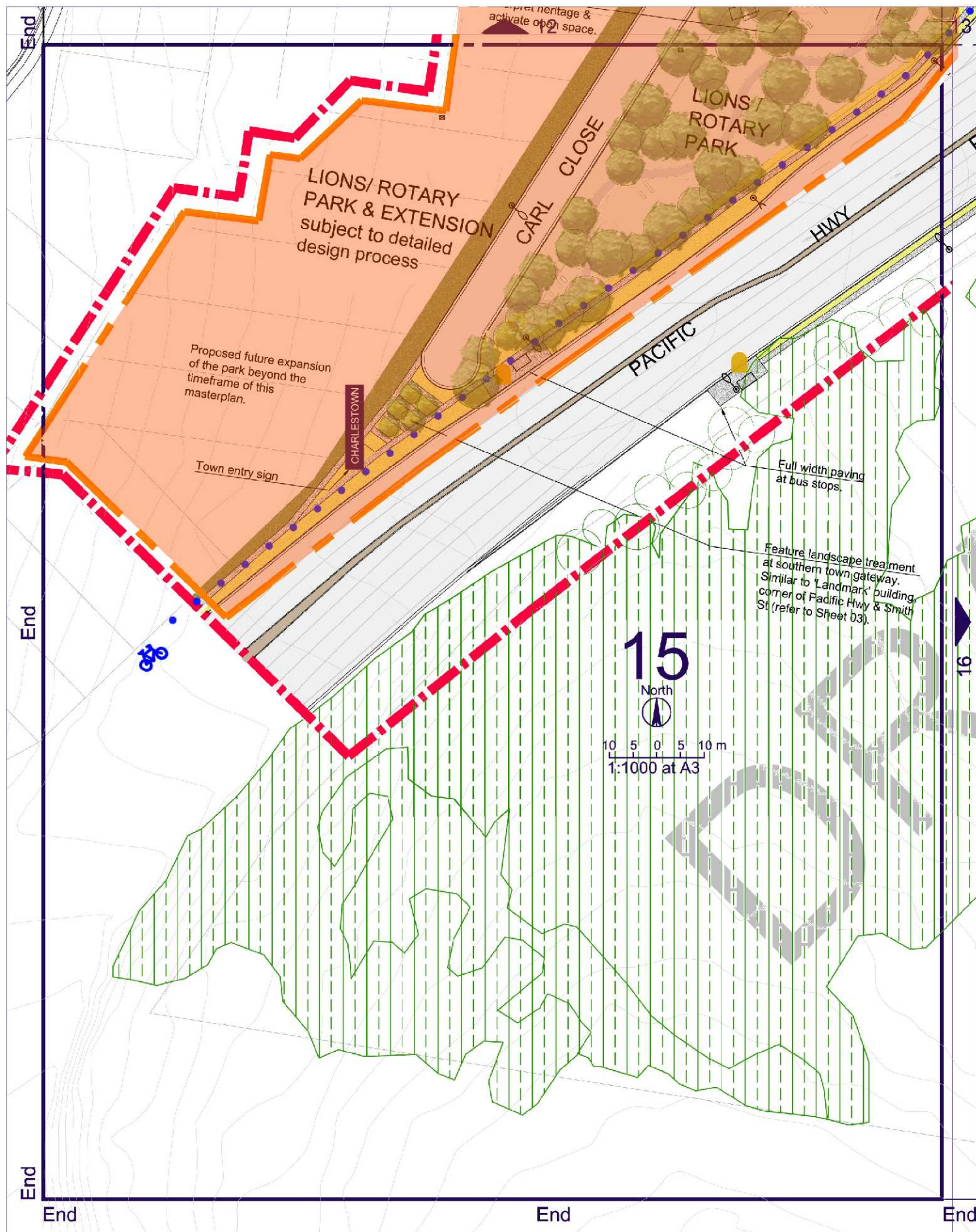

Charlestown Lions / Rotary Park Character Images: A materials palette similar to the oval.

GENERAL NOTE: Refer to the Streetscape Technical Guidelines for all furniture, paving, planting and public art specifications. Refer to page 4 of this document for the plan legend.

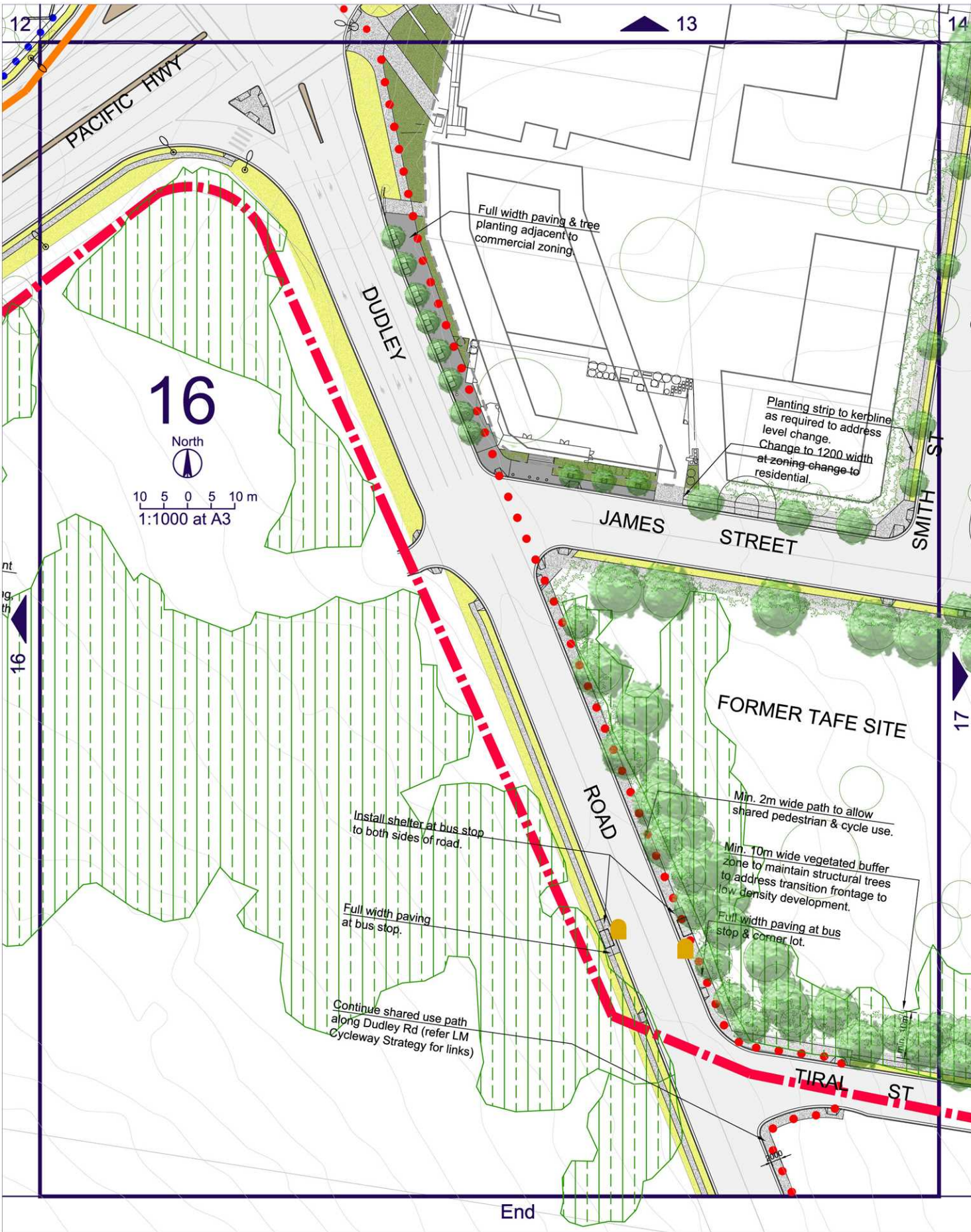

Dudley Road: Min 2m wide pathway along northern side of Dudley Road to allow for shared pedestrian / cycle use. Full width paving and shelters to bus stop both sides of street.



Tiral Street: Vegetation along the southern boundary to be retained.



James St: Full width paving to Commercial zoning. 1200mm wide paving to residential zoning.

GENERAL NOTE: Refer to the Streetscape Technical Guidelines for all furniture, paving, planting and public art specifications. Refer to page 4 of this document for the plan legend.

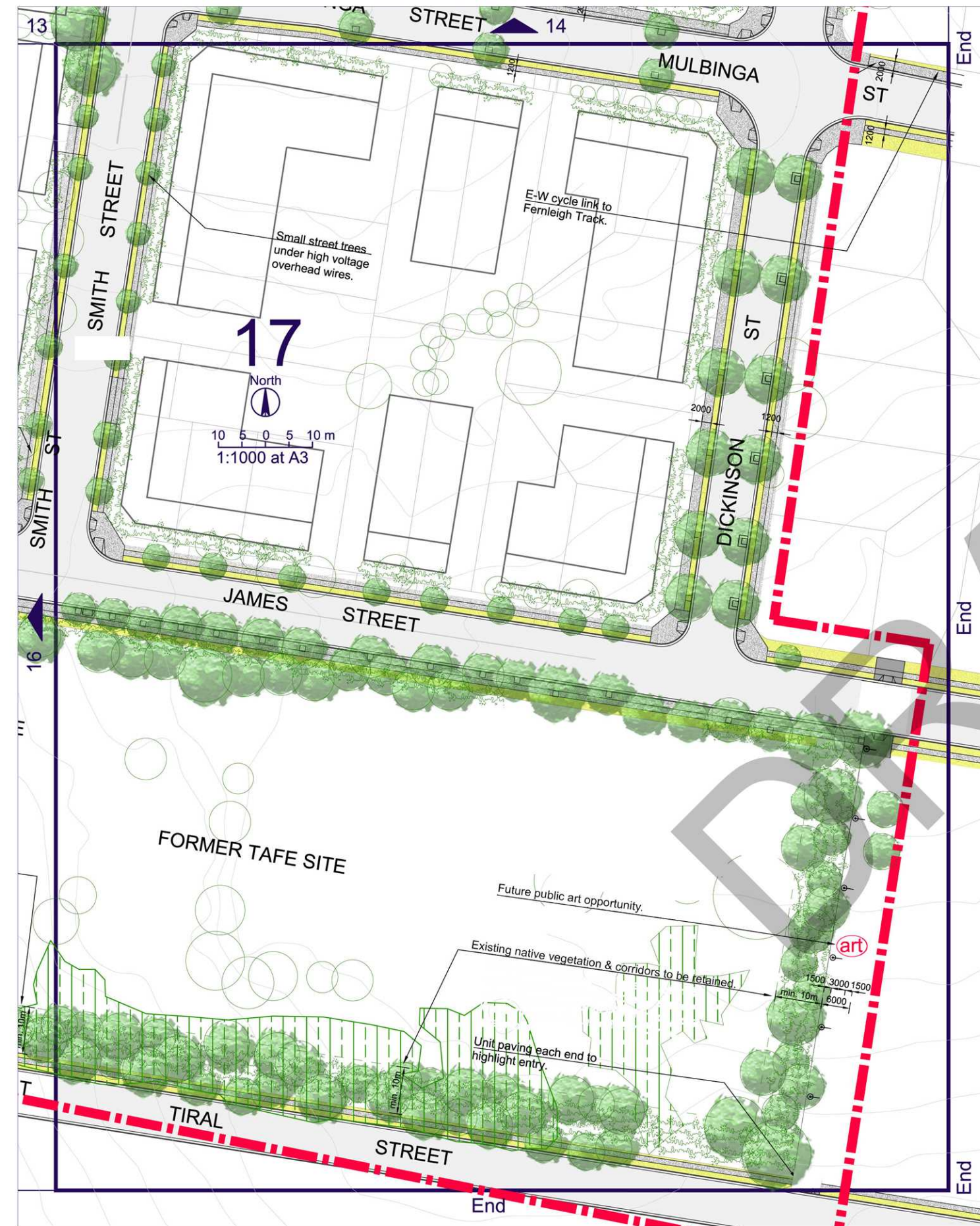

GENERAL NOTE: Refer to the Streetscape Technical Guidelines for all furniture, paving, planting and public art specifications. Refer to page 4 of this document for the plan legend.

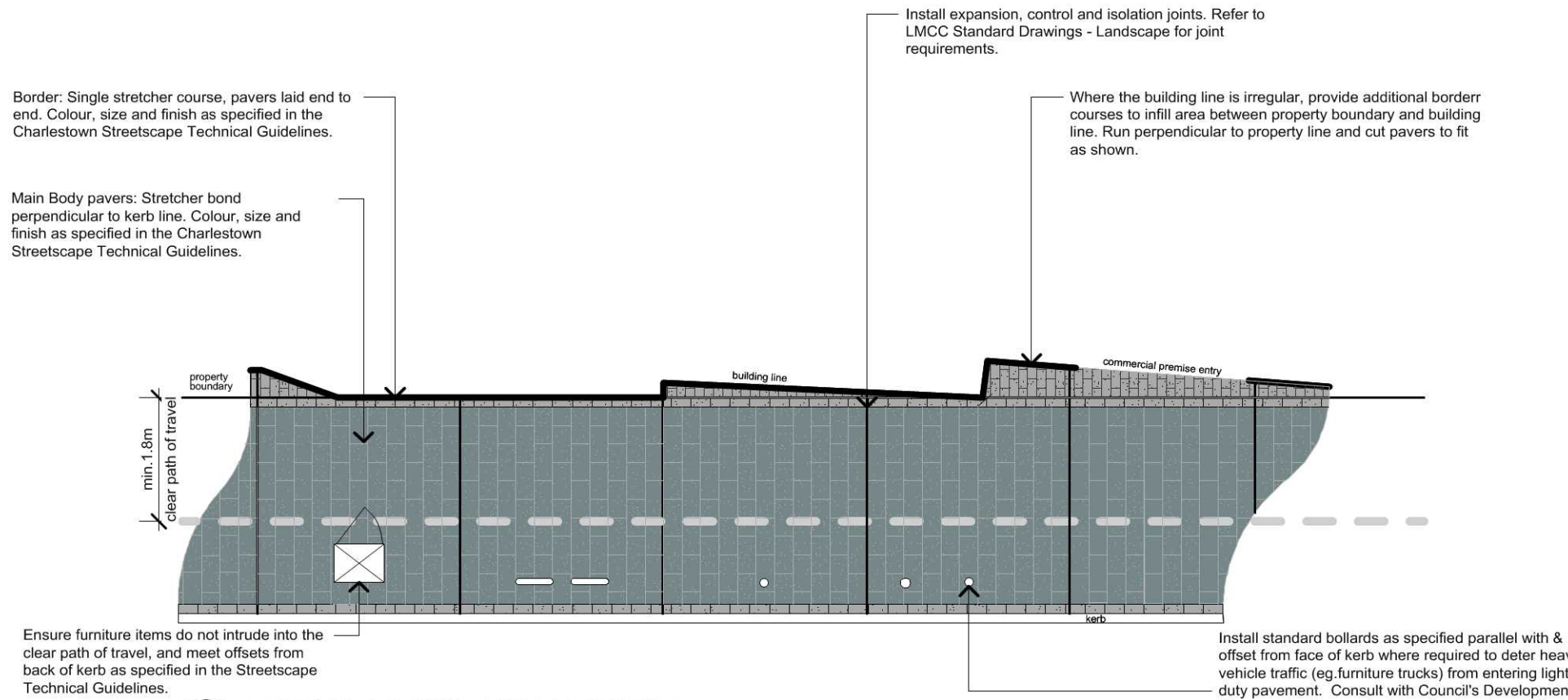

1 TYPICAL PAVING TYPE 1 LAYOUT
Scale:NTS

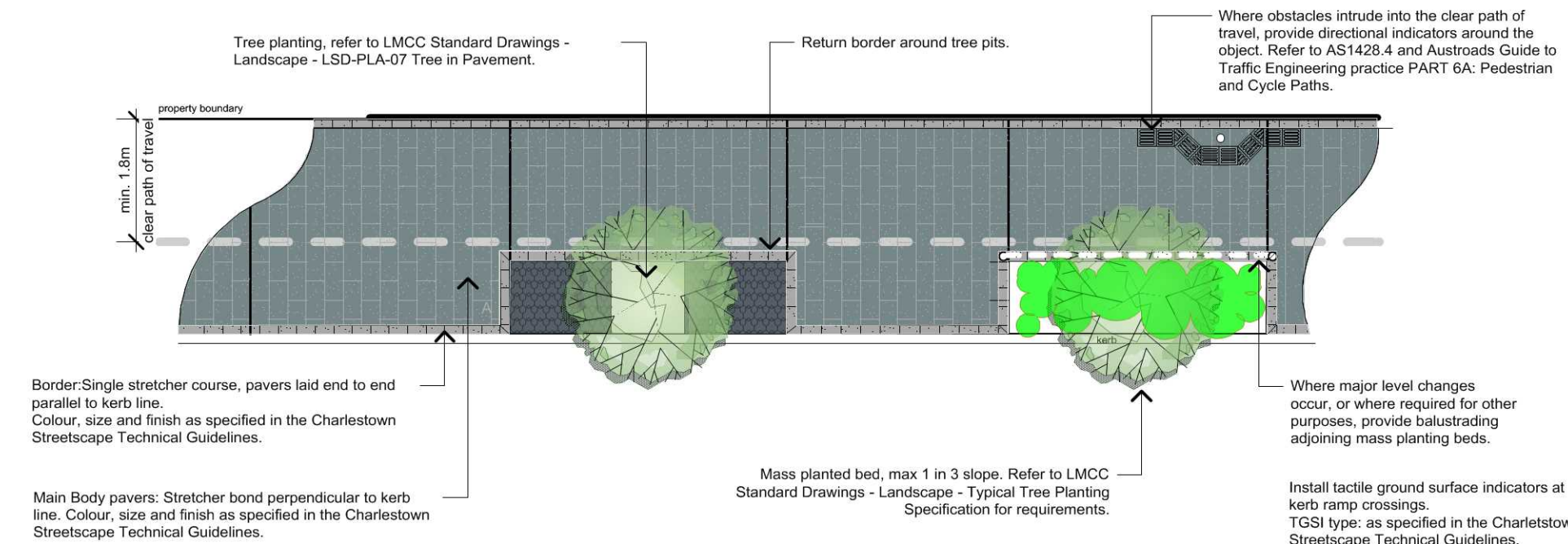

2 TYPICAL PAVING TYPE 1 LAYOUT AT TREE PLANTINGS
Scale:NTS

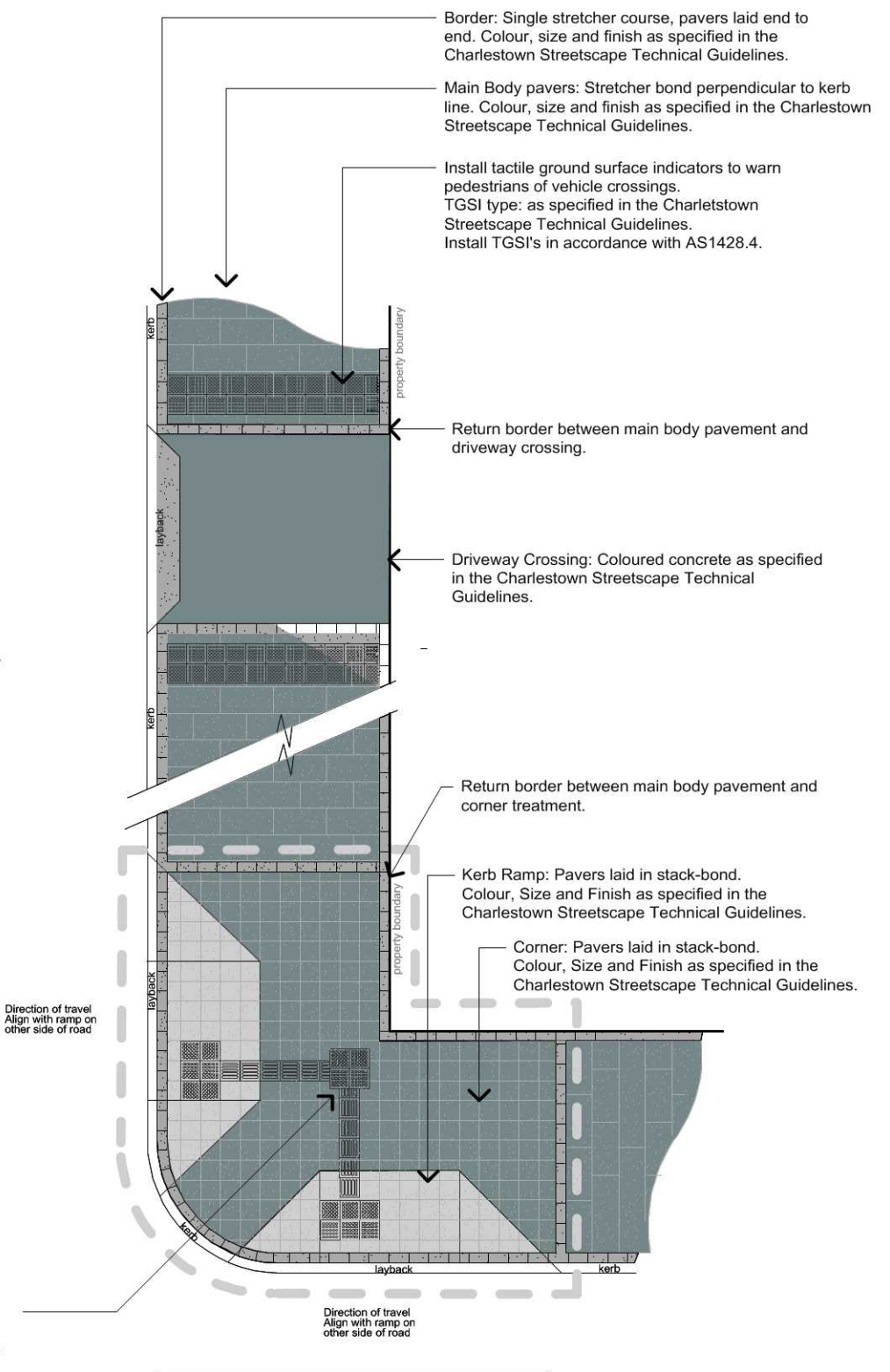

3 TYPICAL PAVING TYPE 1 LAYOUT AT CORNERS + DRIVEWAY CROSSINGS
Scale:NTS

This drawing is typical only and requires site specific documentation for different intersections.

GENERAL NOTE: Refer to the Streetscape Technical Guidelines for all furniture, paving, planting and public art specifications. Refer to page 3 of this document for the location of pavement types.

This drawing is typical only and requires site specific documentation for different intersections.

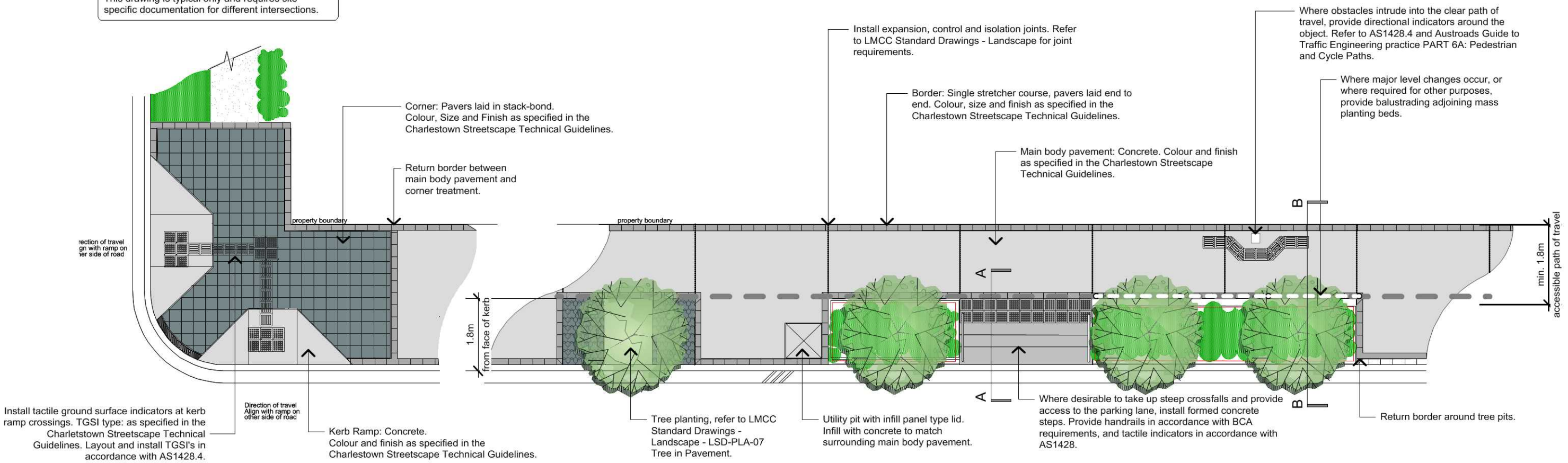

1 TYPICAL PAVING TYPE 2 CORNER TREATMENT
Scale:NTS

2 TYPICAL PAVING TYPE 2 TYPICAL LAYOUT
Scale:NTS

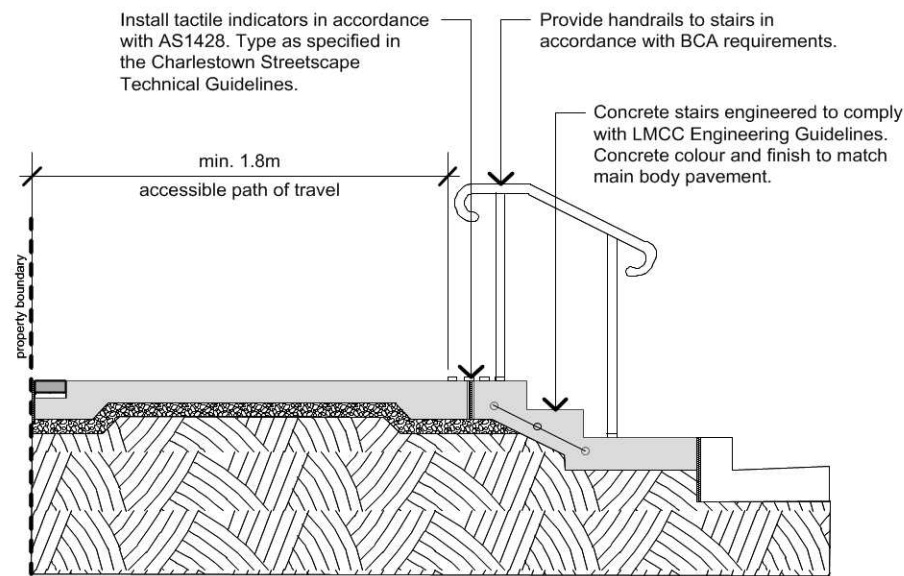

A-A TYPICAL SECTION - PAVING TYPE 2 STEPS
Scale:NTS

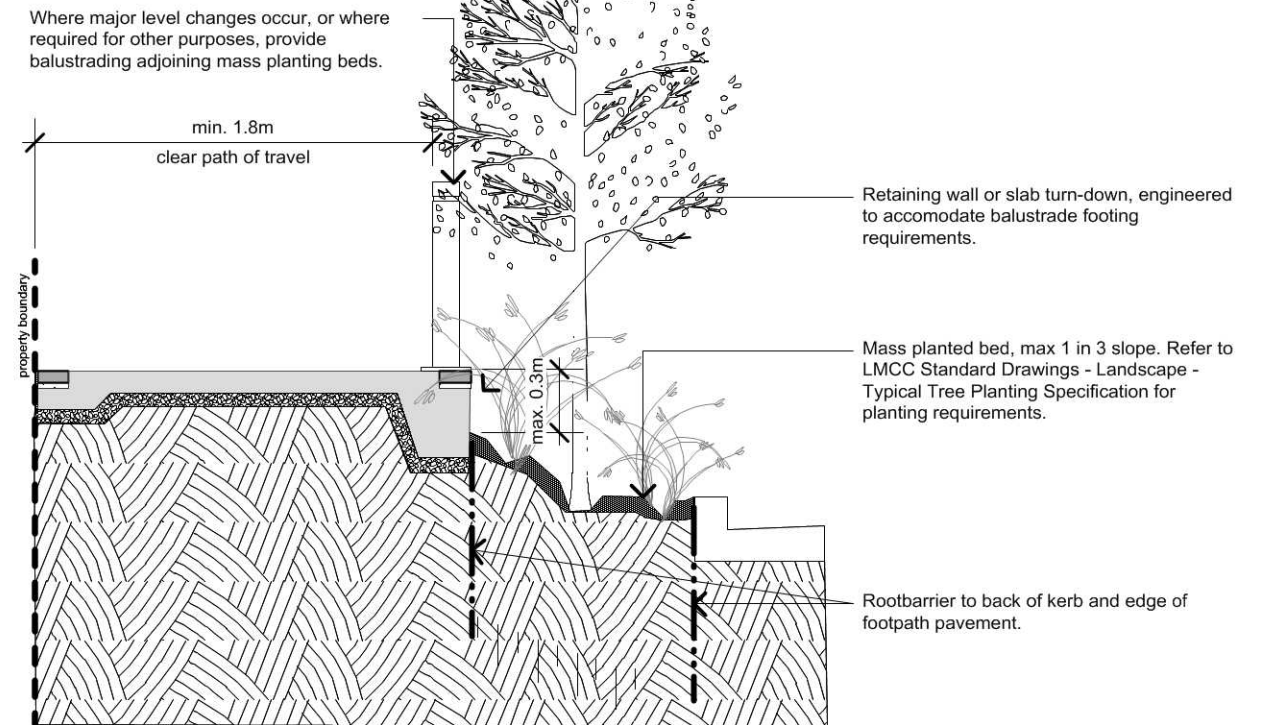

B-B TYPICAL SECTION - PAVING TYPE 2 KERBSIDE GARDEN BED
Scale:NTS

GENERAL NOTE: Refer to the Streetscape Technical Guidelines for all furniture, paving, planting and public art specifications. Refer to page 3 of this document for the location of pavement types.

This drawing is typical only and requires site specific documentation for different intersections.

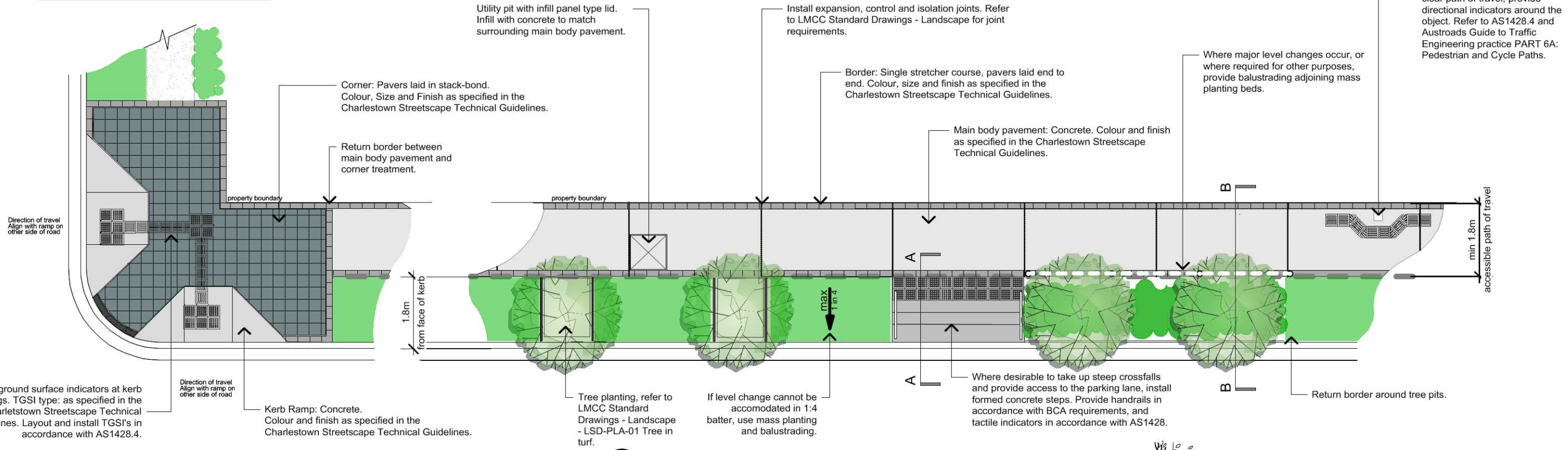

1 TYPICAL PAVING TYPE 3 CORNER TREATMENT
Scale:NTS

2 TYPICAL PAVING TYPE 3 TYPICAL LAYOUT
Scale:NTS

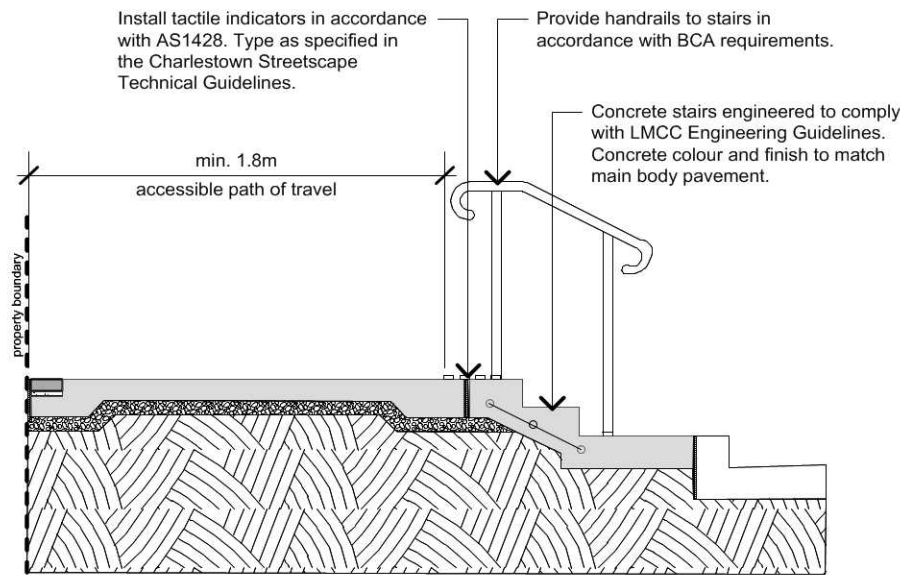

A-A TYPICAL SECTION - PAVING TYPE 3 STEPS
Scale:NTS

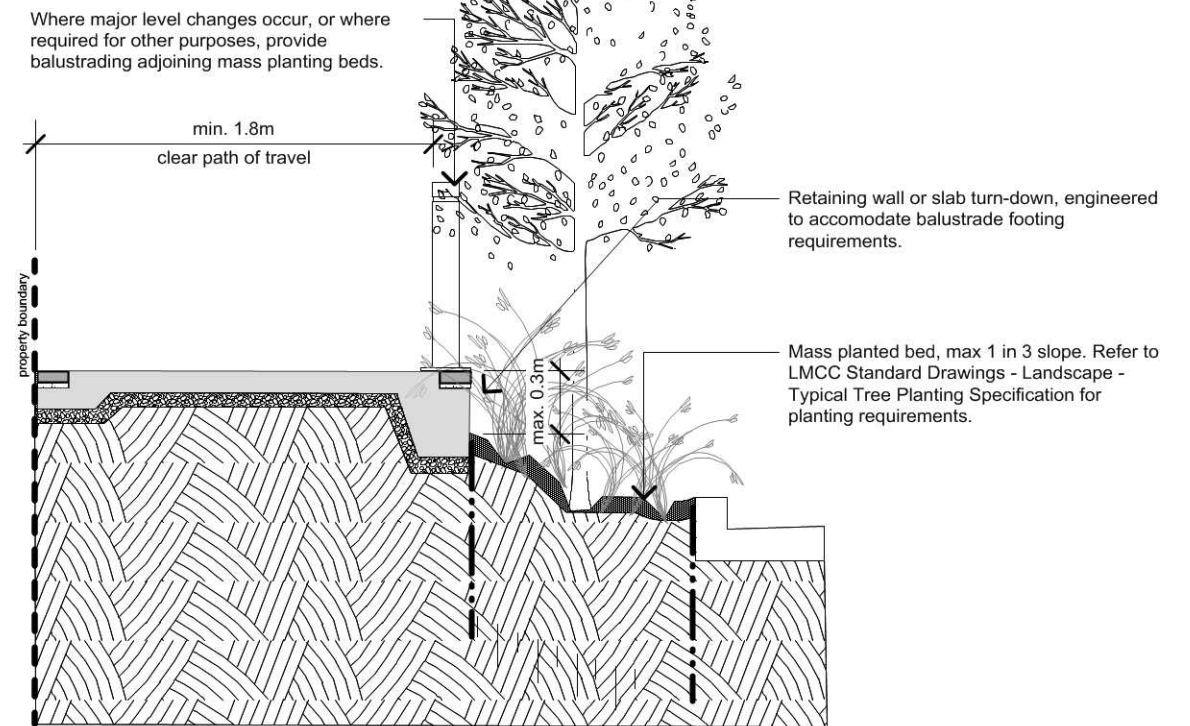

B-B TYPICAL SECTION - PAVING TYPE 3 KERBSIDE GARDEN BED
Scale:NTS

GENERAL NOTE: Refer to the Streetscape Technical Guidelines for all furniture, paving, planting and public art specifications. Refer to page 3 of this document for the location of pavement types.



DRAFT